

*Lightblade*

# QK-LEDKIT

High Visibility Neon Effect Lighting System for ICARUS series Automatic Barriers

E  
N  
G  
L  
I  
S  
H

- QK-LEDKIT3 for 3m barriers
- QK-LEDKIT4 for 4m barriers
- QK-LEDKIT5 for 5m barriers
- QK-LEDKIT6 for 6m barriers



**qui>lo:**<sup>®</sup>  
opening solutions

use and maintenance manual

The system can be installed on brand new or pre-existing automatic barriers of QUIKO of ICARUS serie

## Contents of the kit:

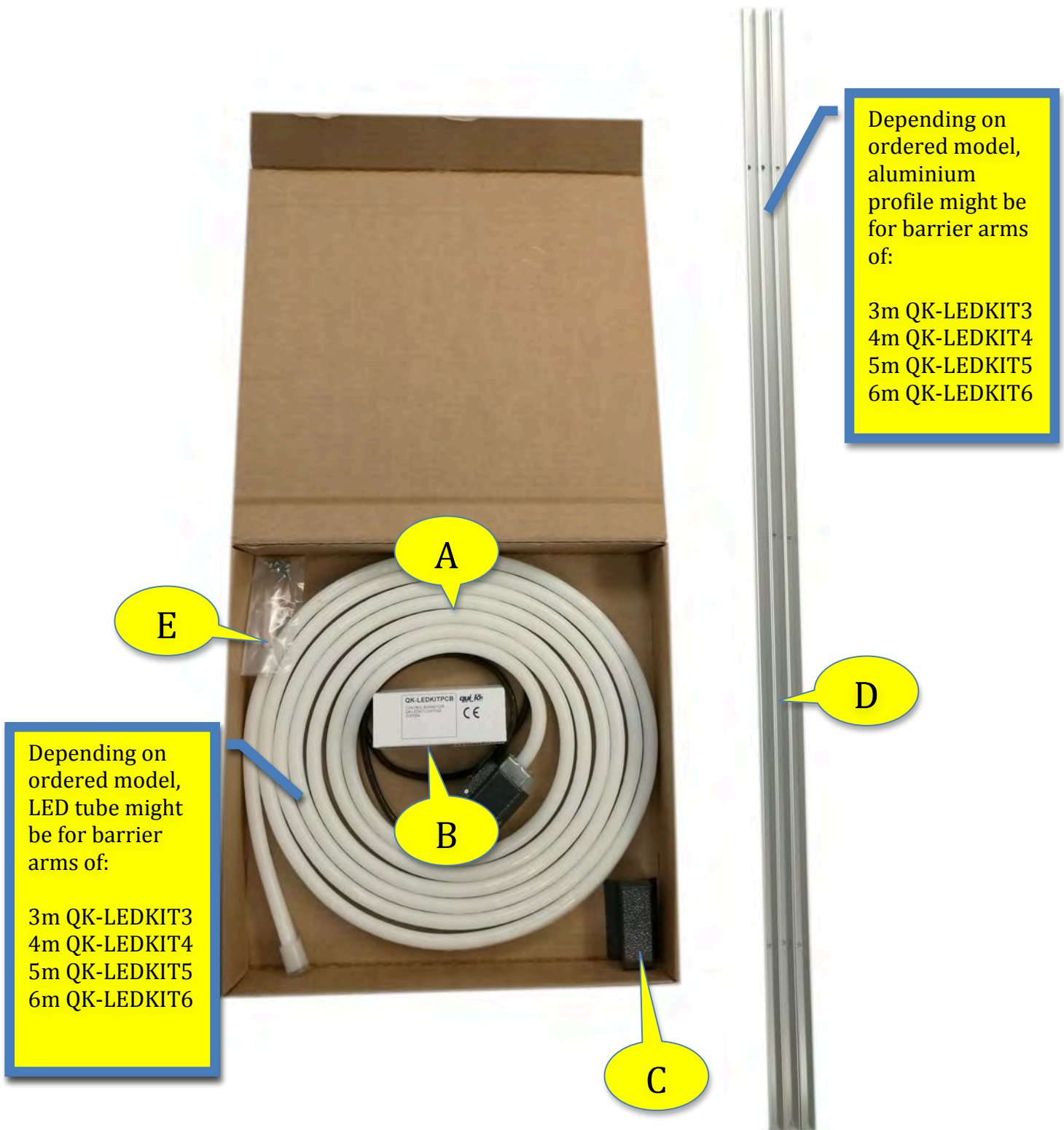

- A : 24V NEON EFFECT LED TUBE FOR 3-4-5-6m BARRIERS
- B : QK-LEDKITPCB CONTROL BOARD FOR QK-LEDKIT LIGHTING SYSTEMS
- C : METAL COVER FOR NEON EFFECT LED TUBE
- D : ALUMINUM PROFILE FOR 3-4-5-6m BARRIERS
- E : SET OF FIXING SCREWS



Following procedure  
is for barrier arms  
going down on the  
left side. For other  
side please select  
opposite holes.

**quikö**  
MADE IN ITALY



Remove Rubber cap  
from barrier housing

**okinb**  
MADE IN ITALY







By means of scissors, cut it inside so to allow passage of LED power supply cable

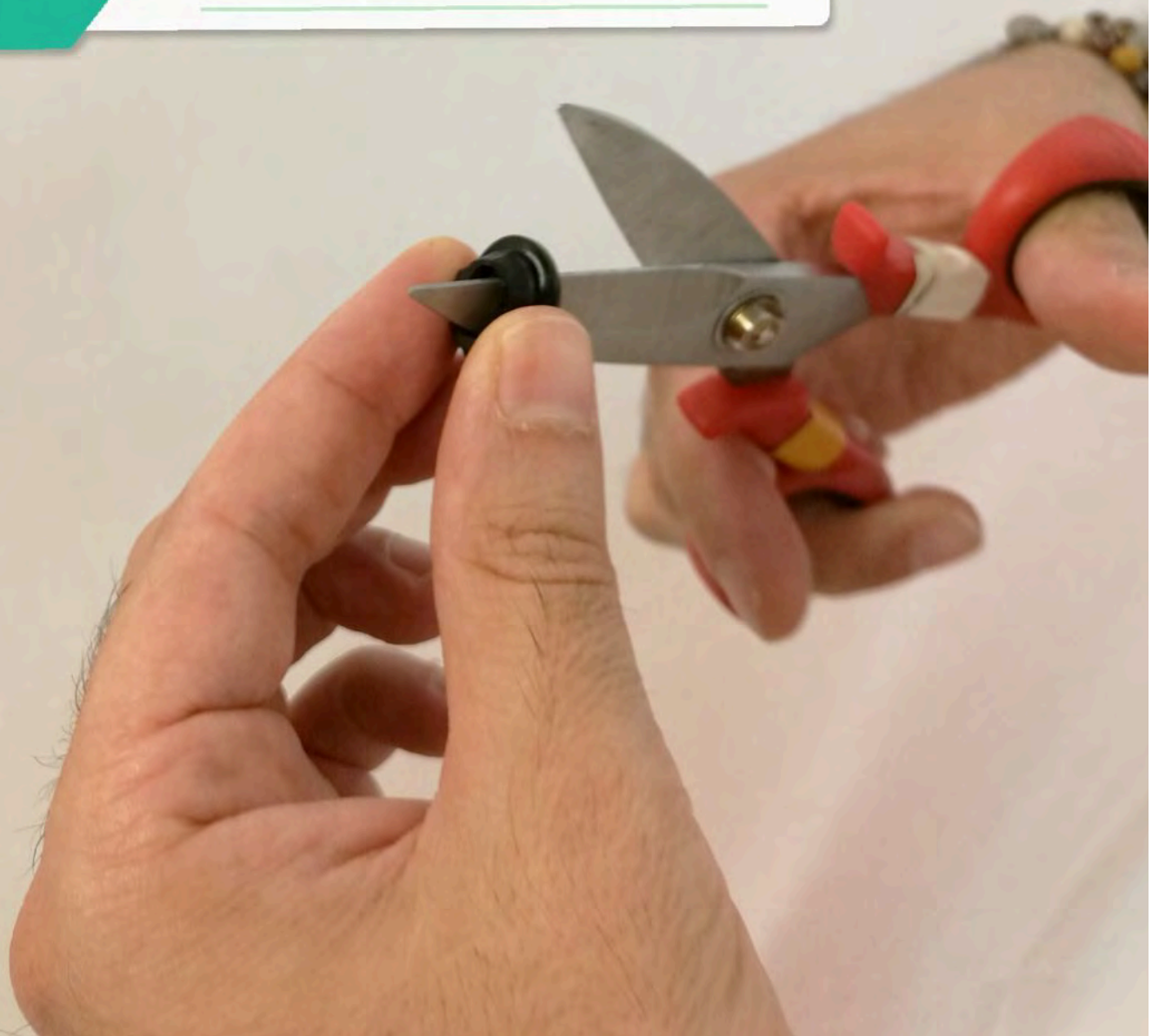







Re-position the rubber cap in its position within barrier metal housing





Get the LED tube  
ready for installation

---





Pay attention on  
handling LED tube with  
care

Bending LED  
tube like in the  
picture won't  
damage the  
product

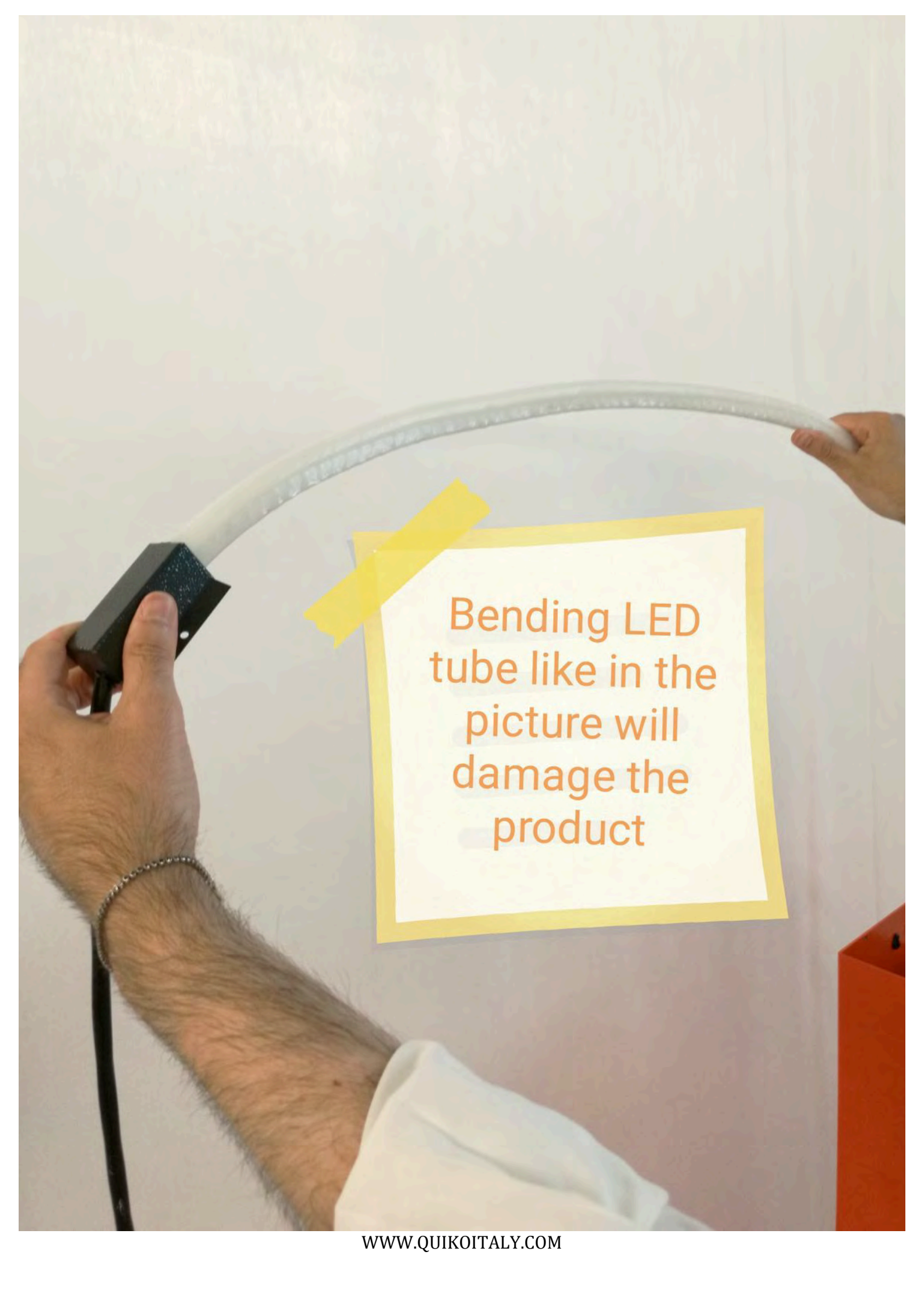
A person is using a heat gun to bend a white LED tube. The tube is held in a curved shape. A yellow-bordered text box is overlaid on the image, containing a warning message. The background is a plain, light-colored wall.

Bending LED  
tube like in the  
picture will  
damage the  
product



Pass power supply  
cable of LED tube through  
hole shown on picture



Leave about 25cm of cable on the other side as shown on picture



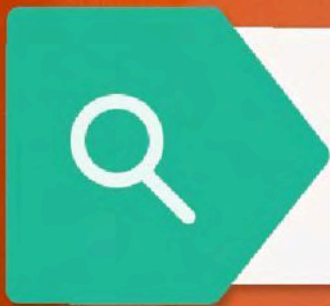
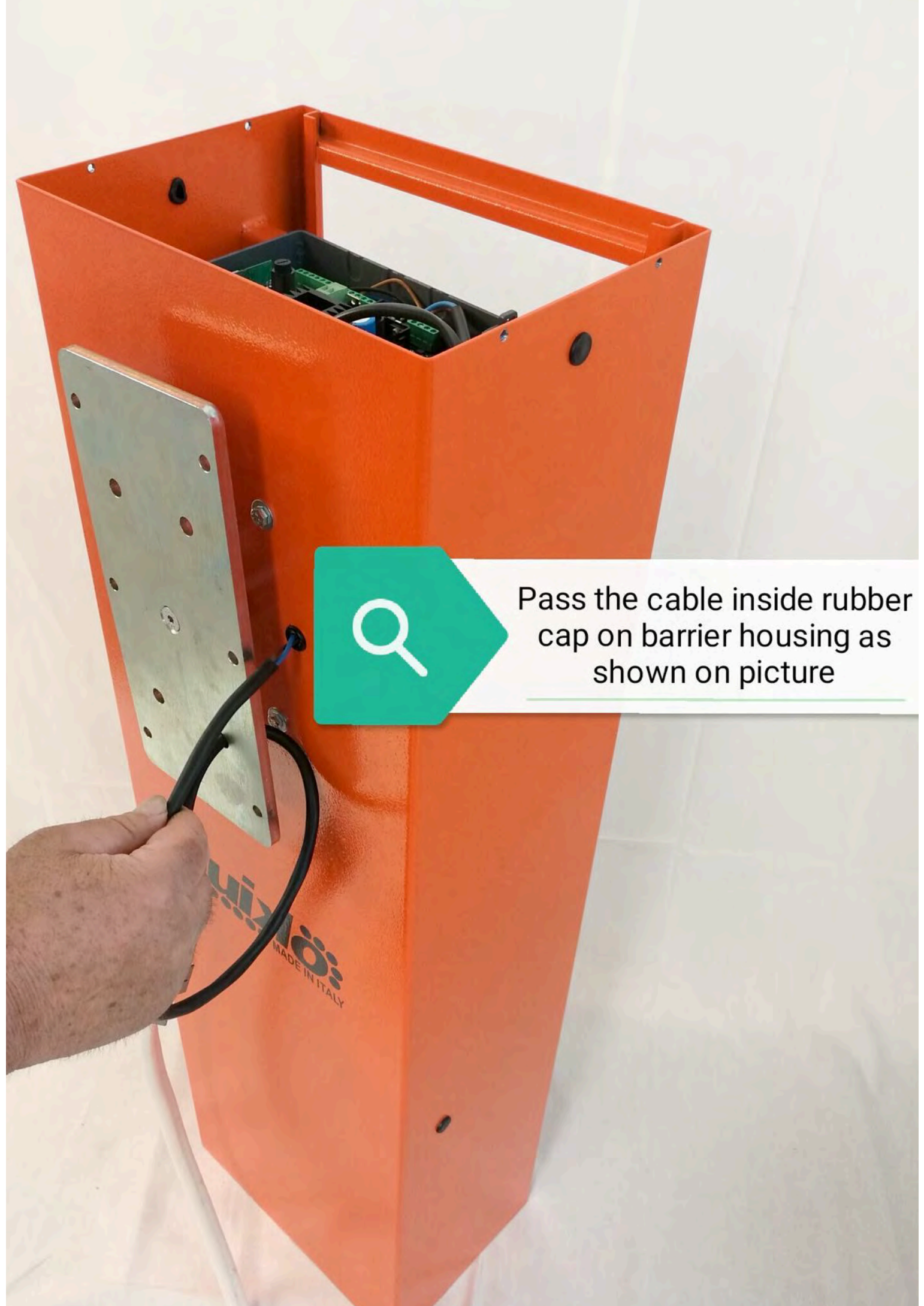

Pass the cable inside rubber cap on barrier housing as shown on picture

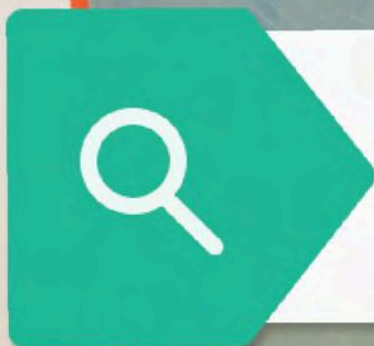

Leave extra cable between barrier housing and barrier arm metal plate, as this will be needed when the arm goes down



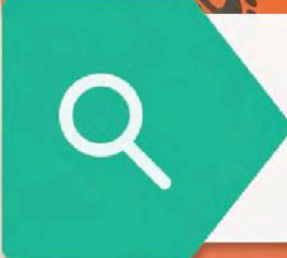
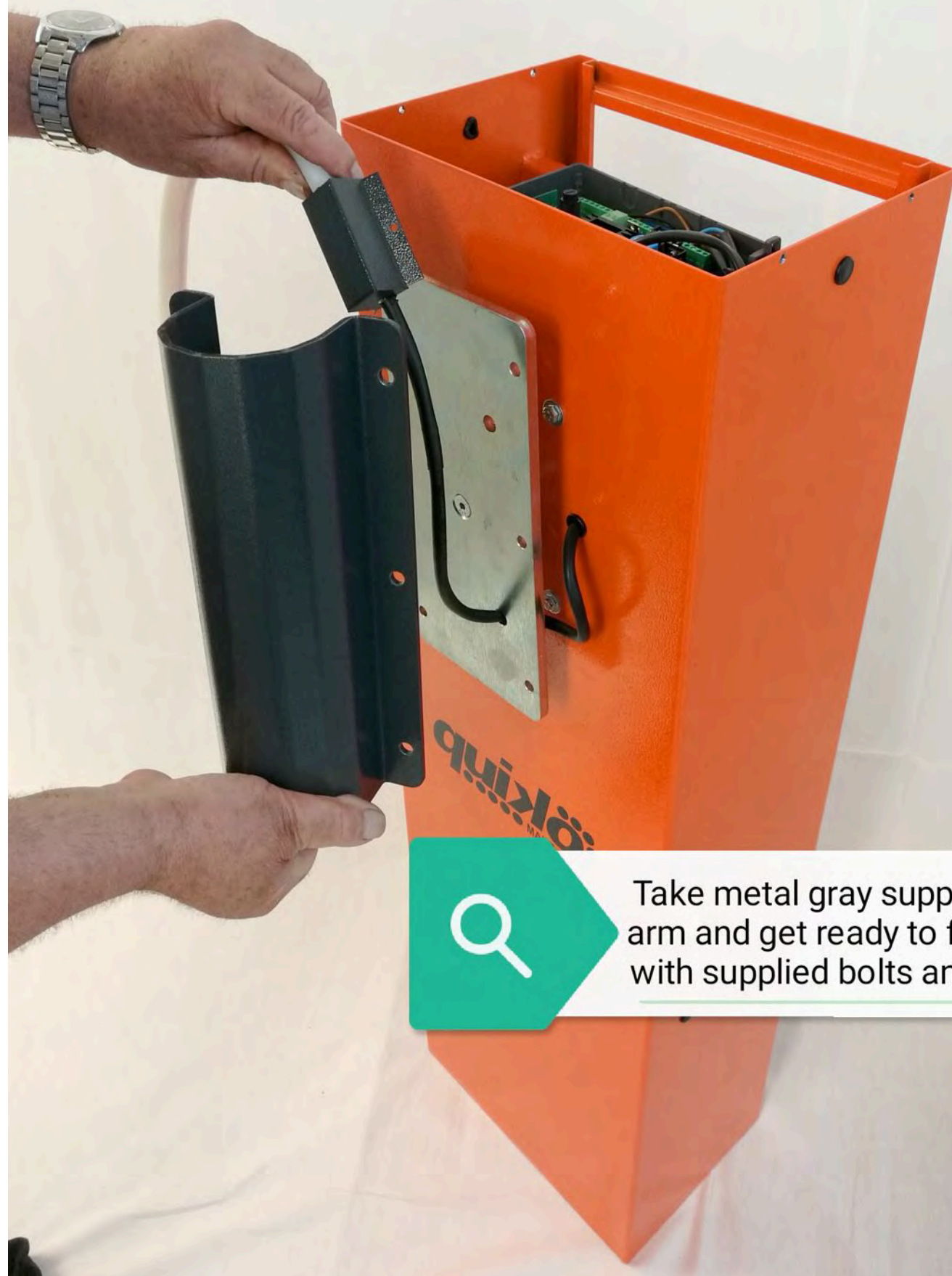

Take metal gray support for arm and get ready to fix it with supplied bolts and nuts

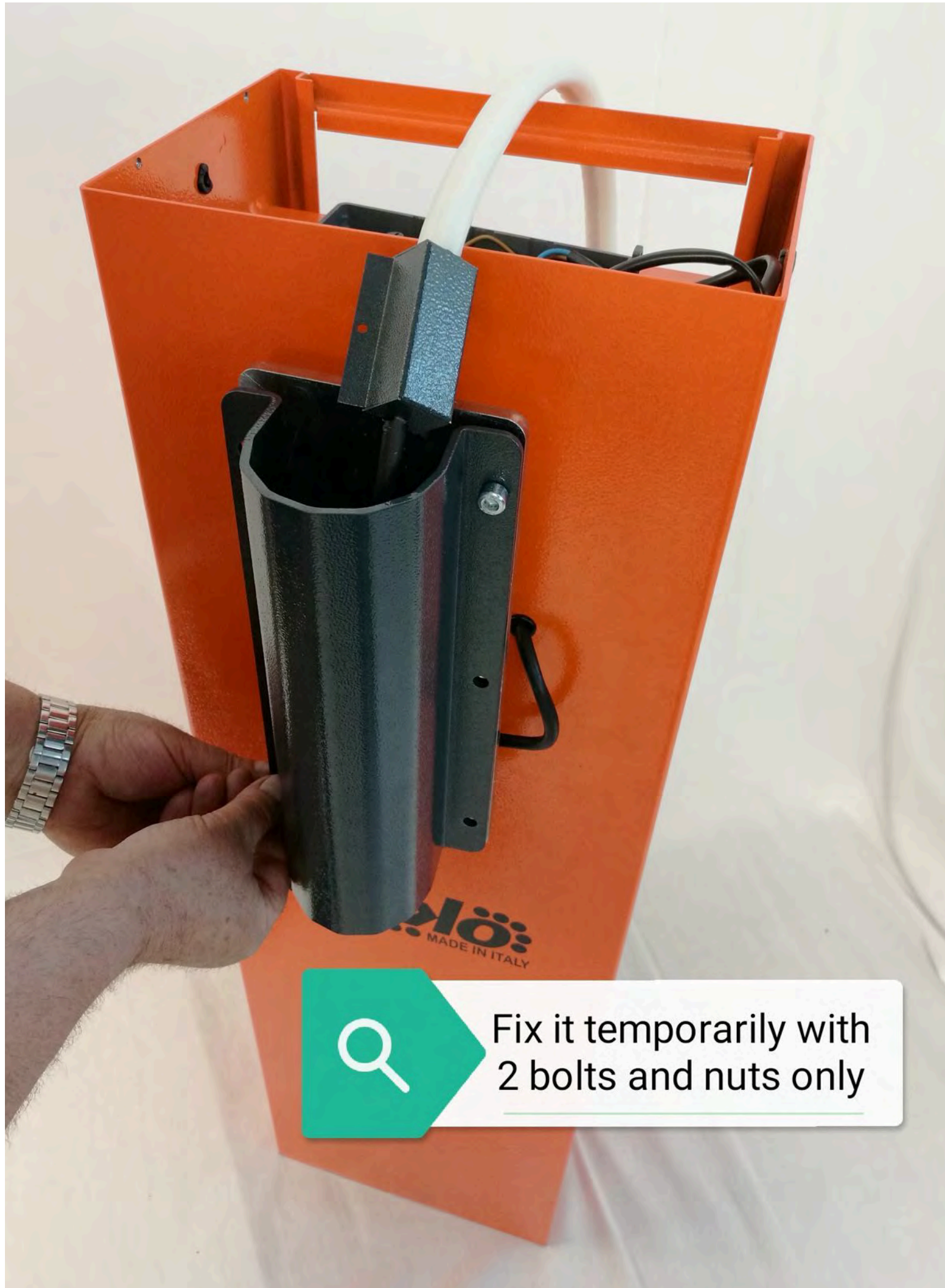

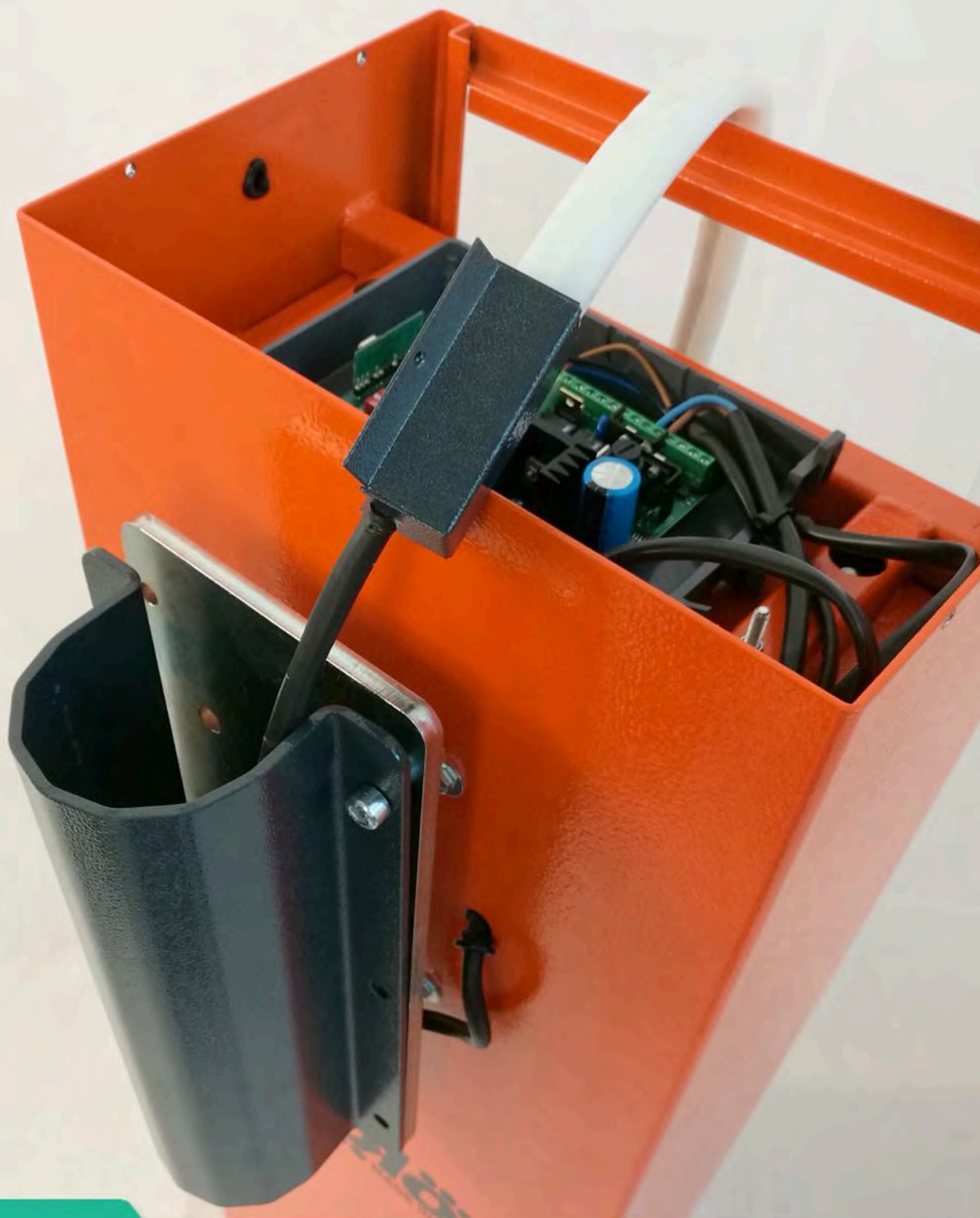

Hold LED tube power supply cable on right side of arm support as shown on picture

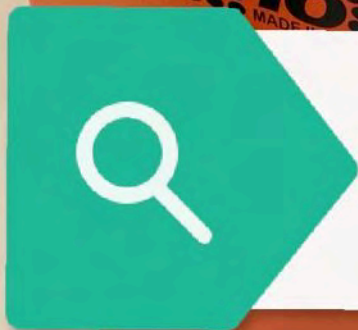

Insert barrier  
arm

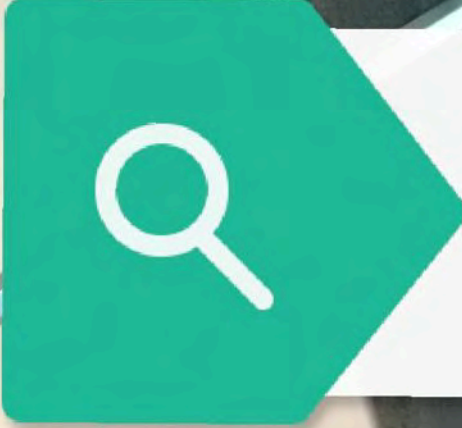
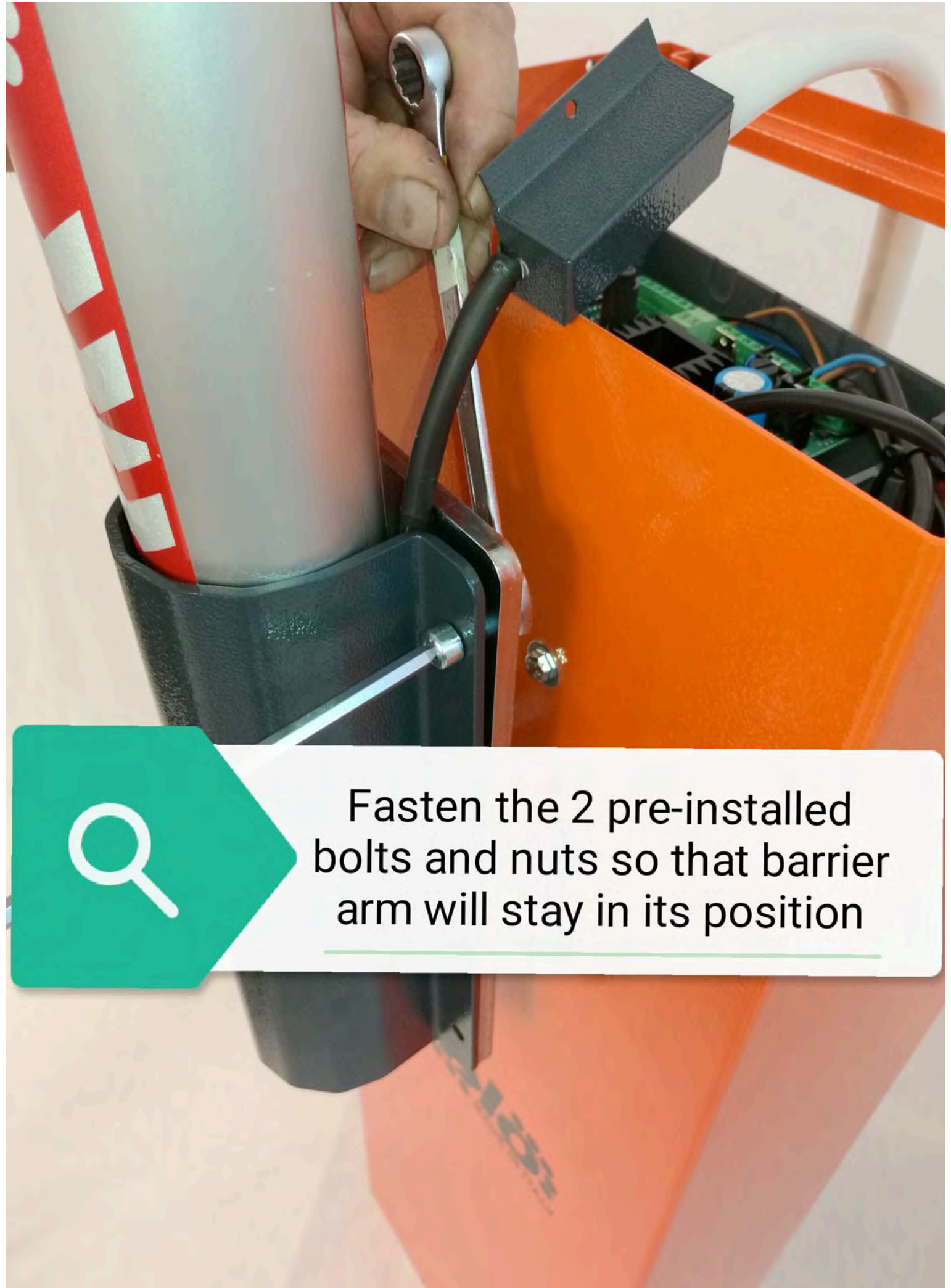

Fasten the 2 pre-installed bolts and nuts so that barrier arm will stay in its position

---

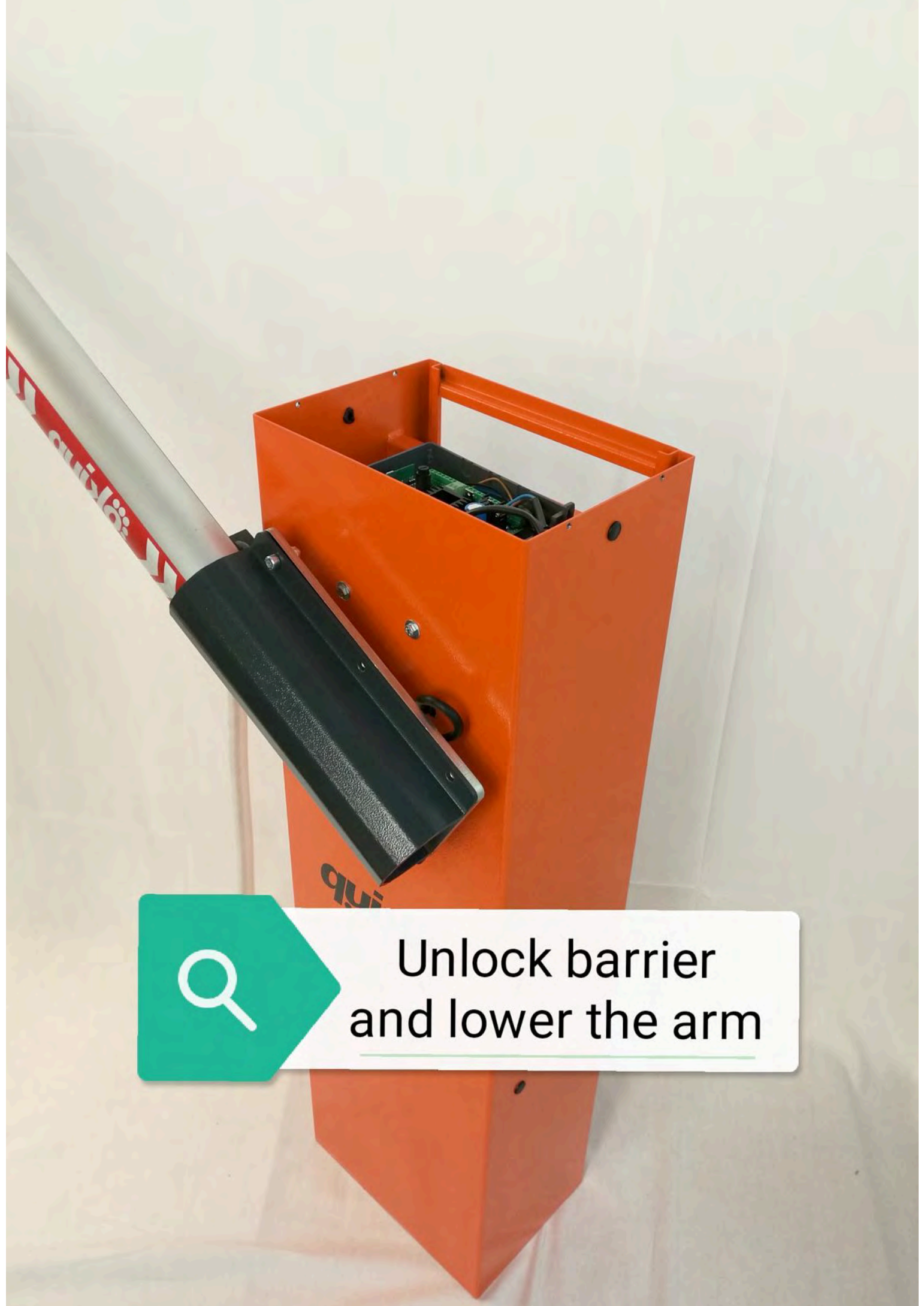

Unlock barrier  
and lower the arm



Position the gray metal cover of LED tube in the center of aluminum arm as shown on picture

---





# Drill first hole

---

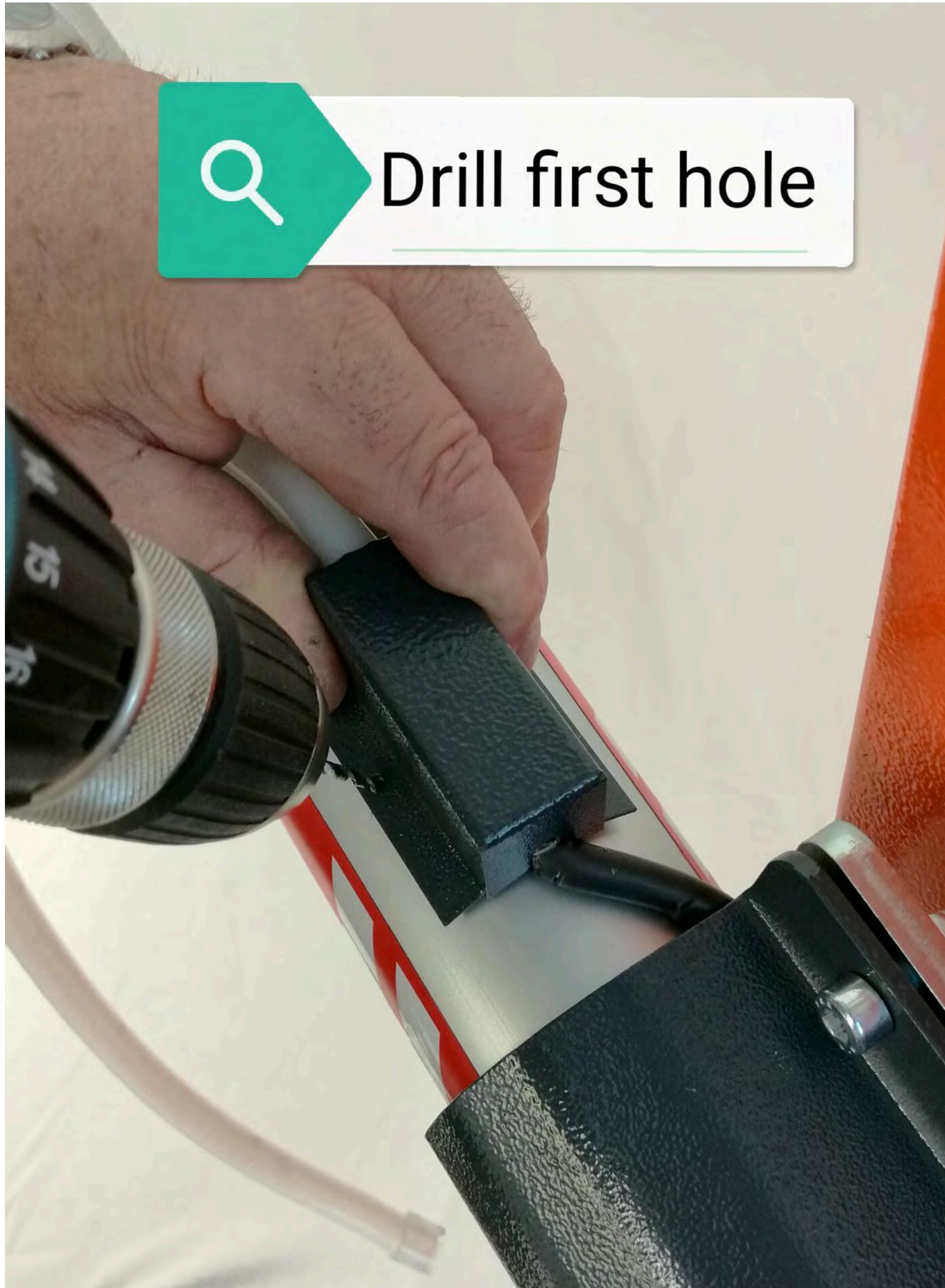





# Position and fasten first fixing screw

---



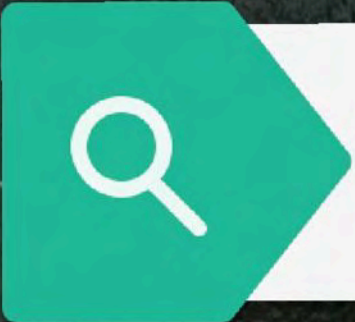
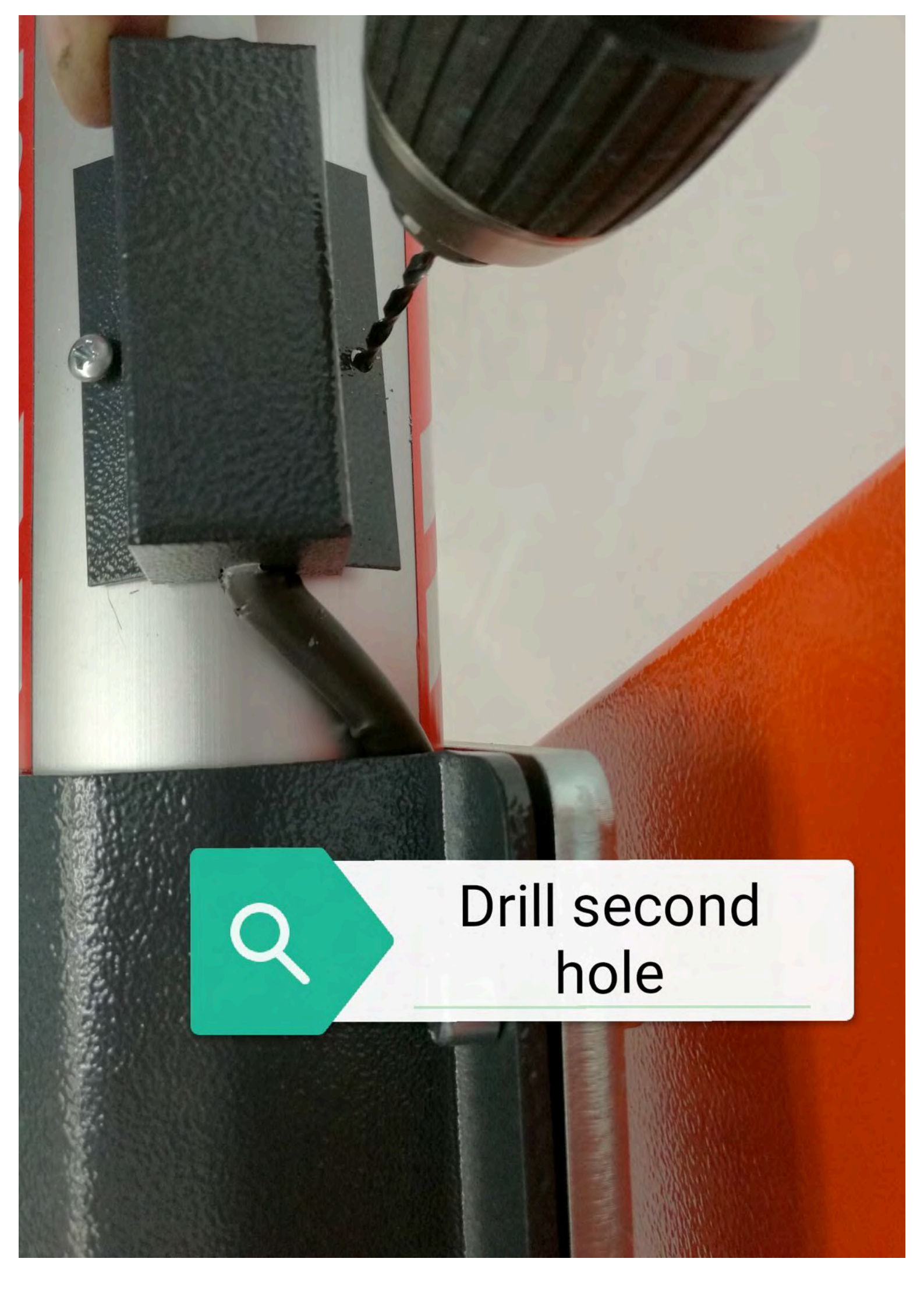

Drill second  
hole



Position and fasten  
second fixing screw

---



Position the supplied aluminium profile for LED tube on barrier arm as shown on picture



Depending on the length of the LED tube kit you have purchased, you have to fix 3-4-5-6 meters of aluminium profile. Each piece of aluminium profile is 1m

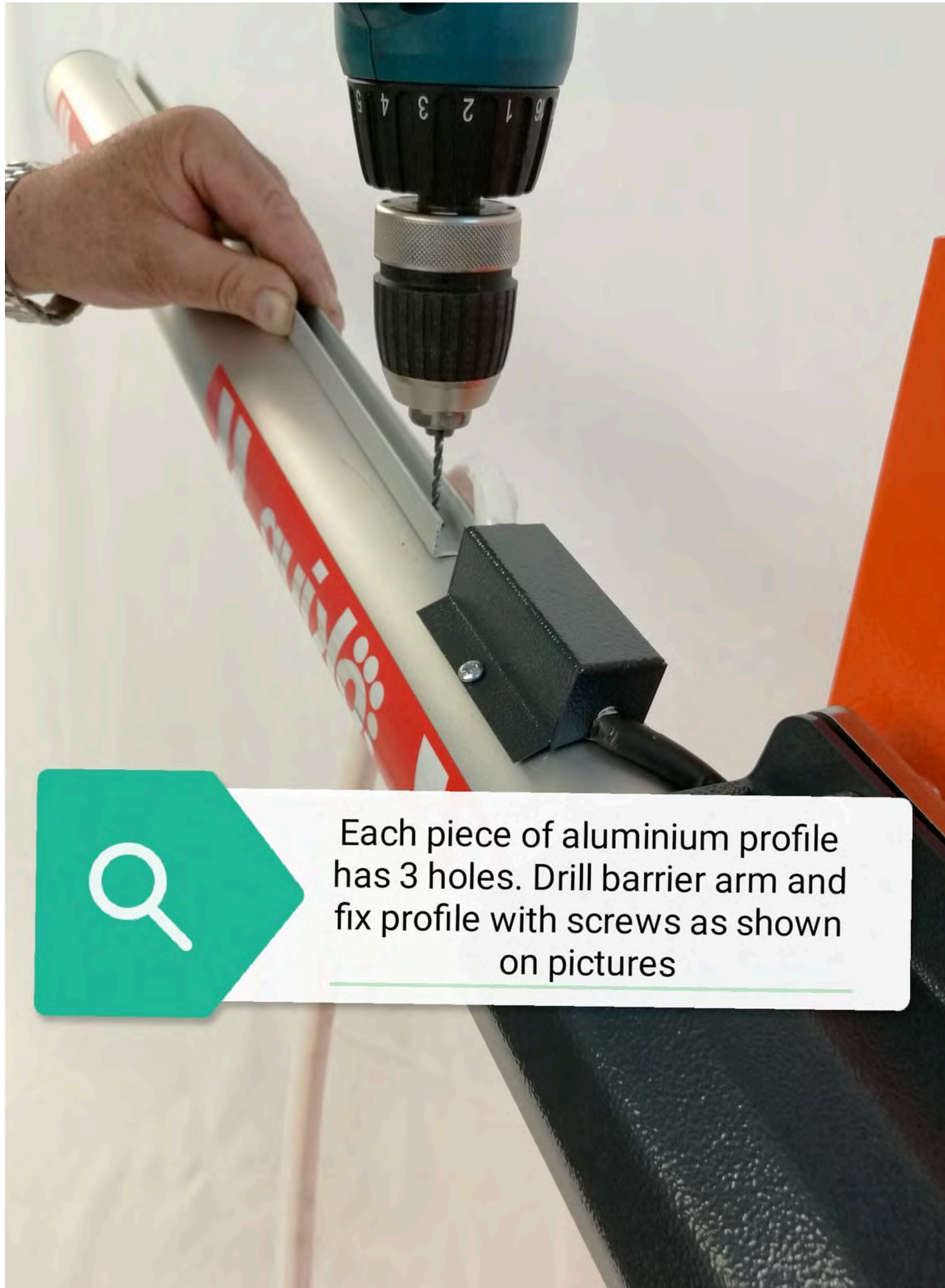

Each piece of aluminium profile has 3 holes. Drill barrier arm and fix profile with screws as shown on pictures



Insert LED tube within  
aluminium profile as  
shown on pictures

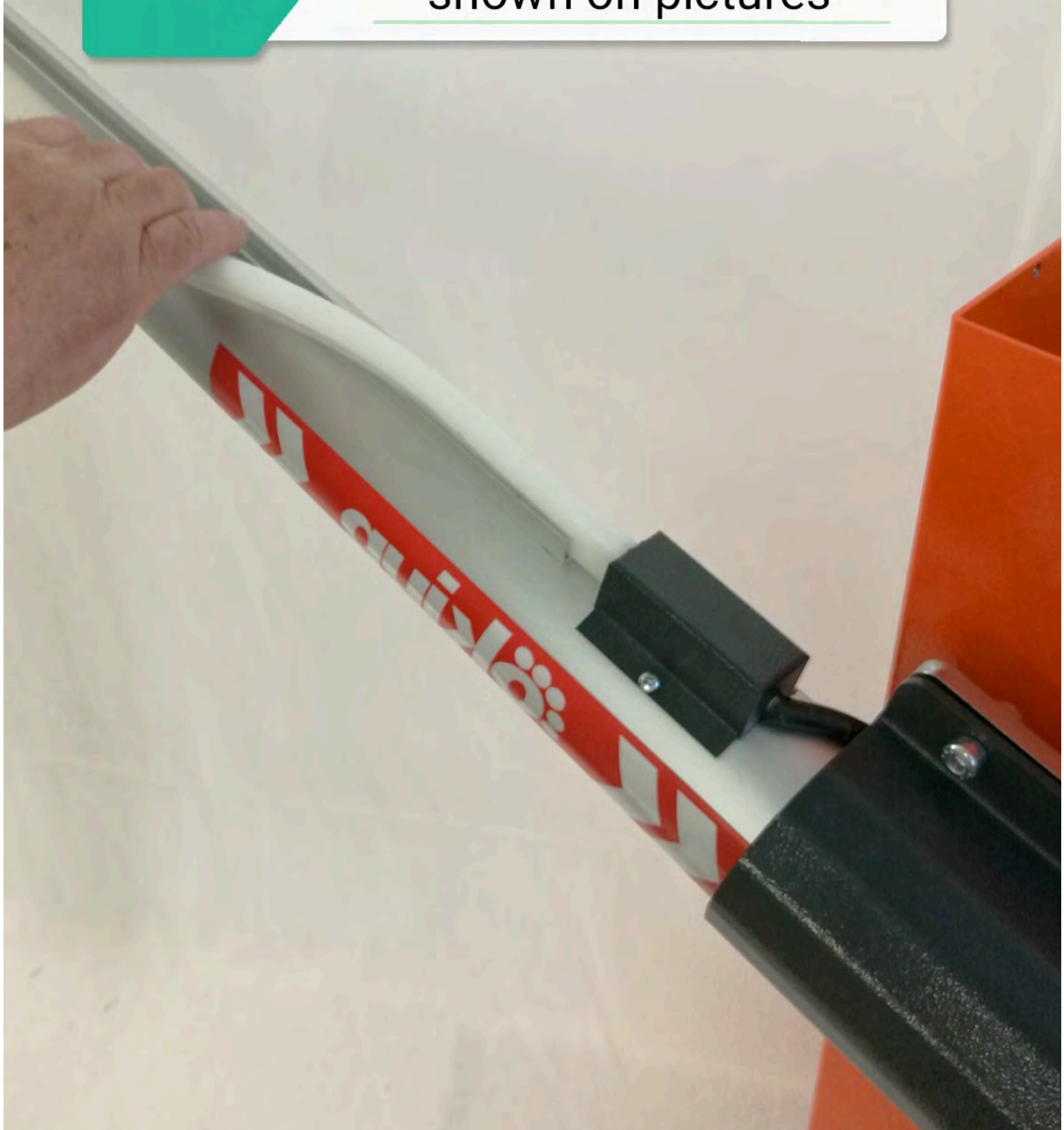



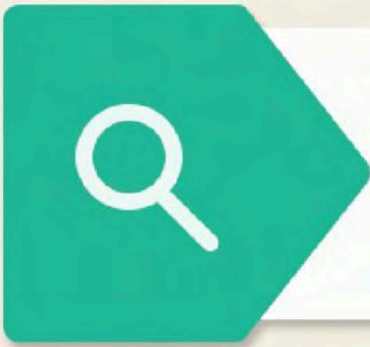

Place metal cover protection  
on last part of LED tube as  
shown on pictures





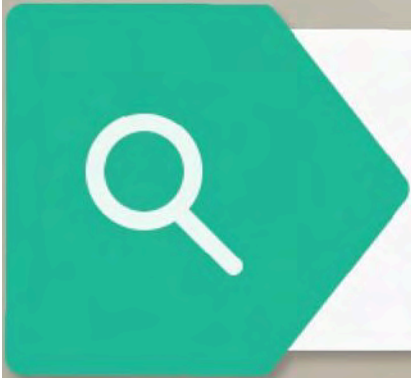
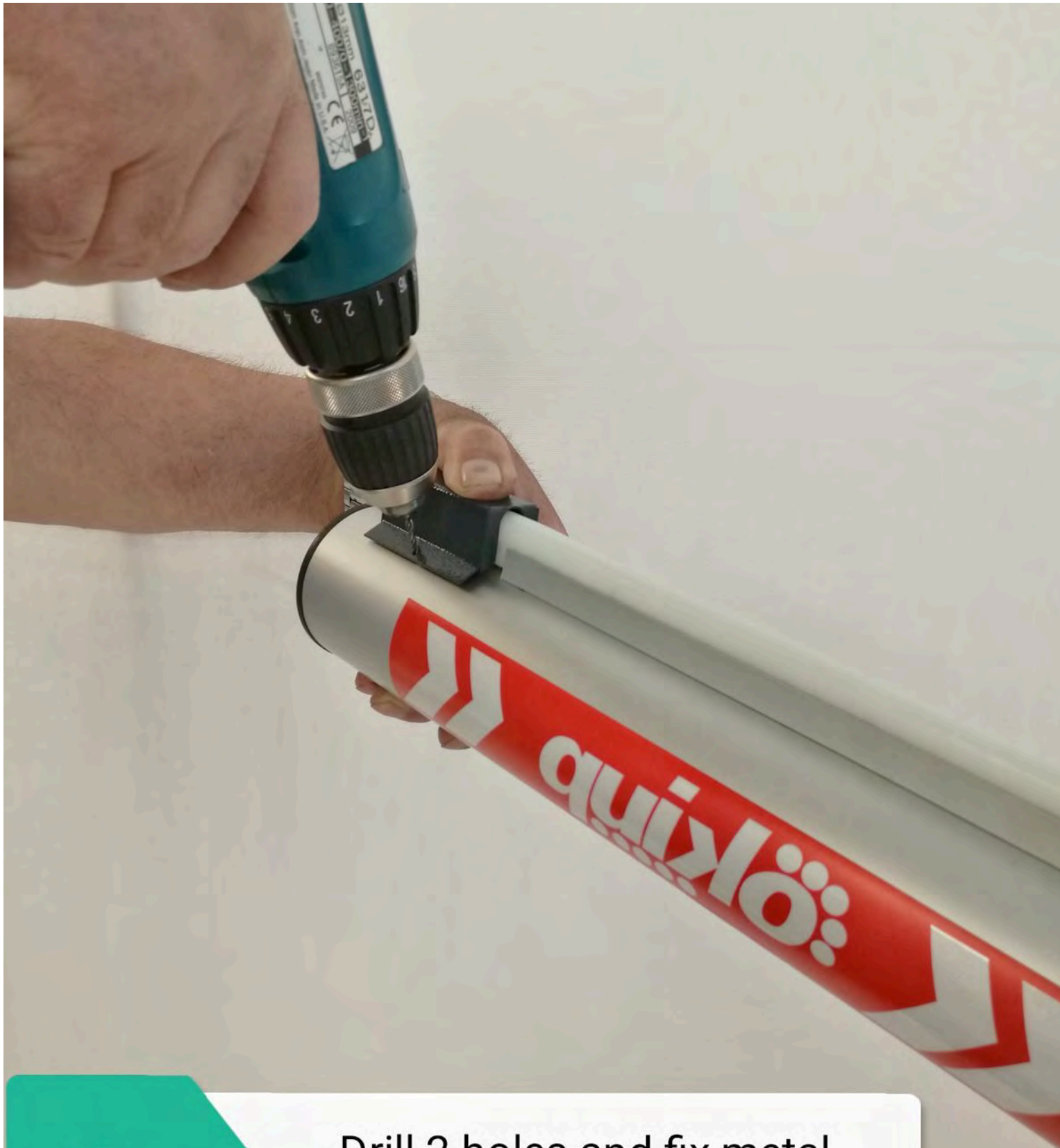

Drill 2 holes and fix metal  
cover protection with screws  
as shown on pictures

---









Take LED tube power supply cable and pass it through the apposite space so to reach the upper control board compartment

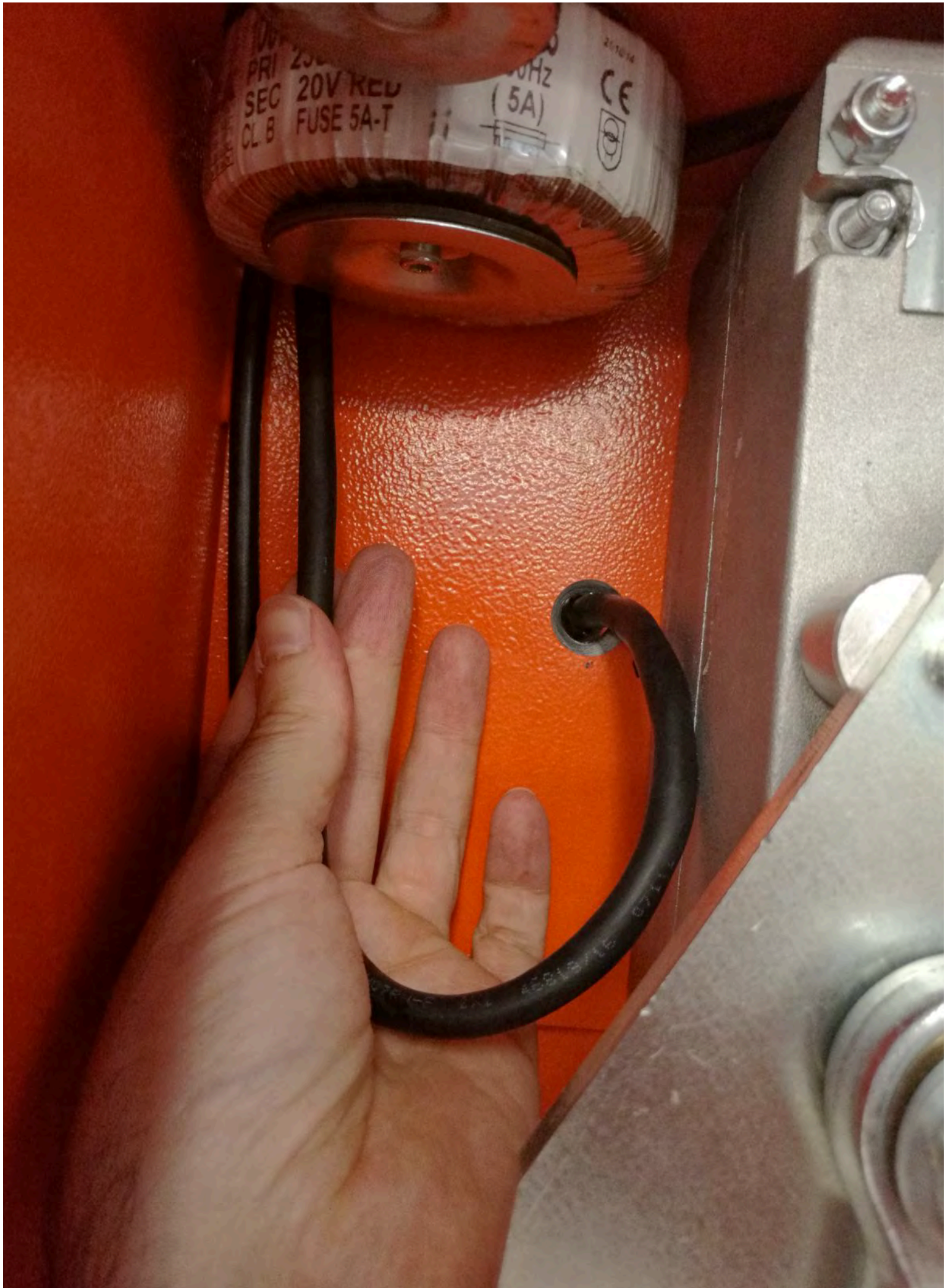



Now extract the LEDKIT Cable from the apposite hole on the top left corner of the barrier and get ready to connect the LEDKIT control card.



Take out LEDKITPCB from its box and connect the cables as shown on the next pages.

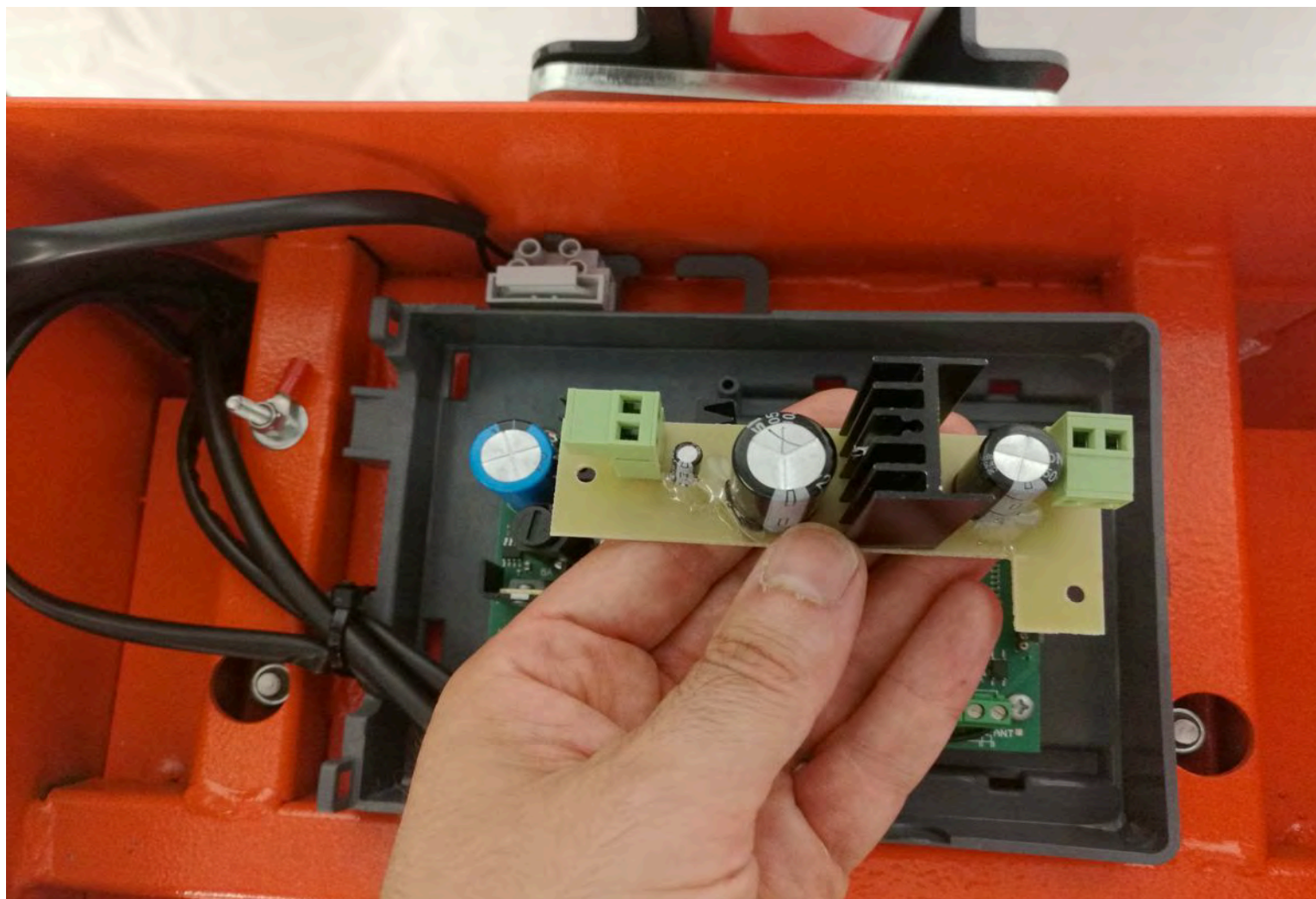





Connect LED tube power supply cable to apposite terminal block of QK-LEDKITPCB, respecting the polarity. Brown cable is (+), blue cable is (-).

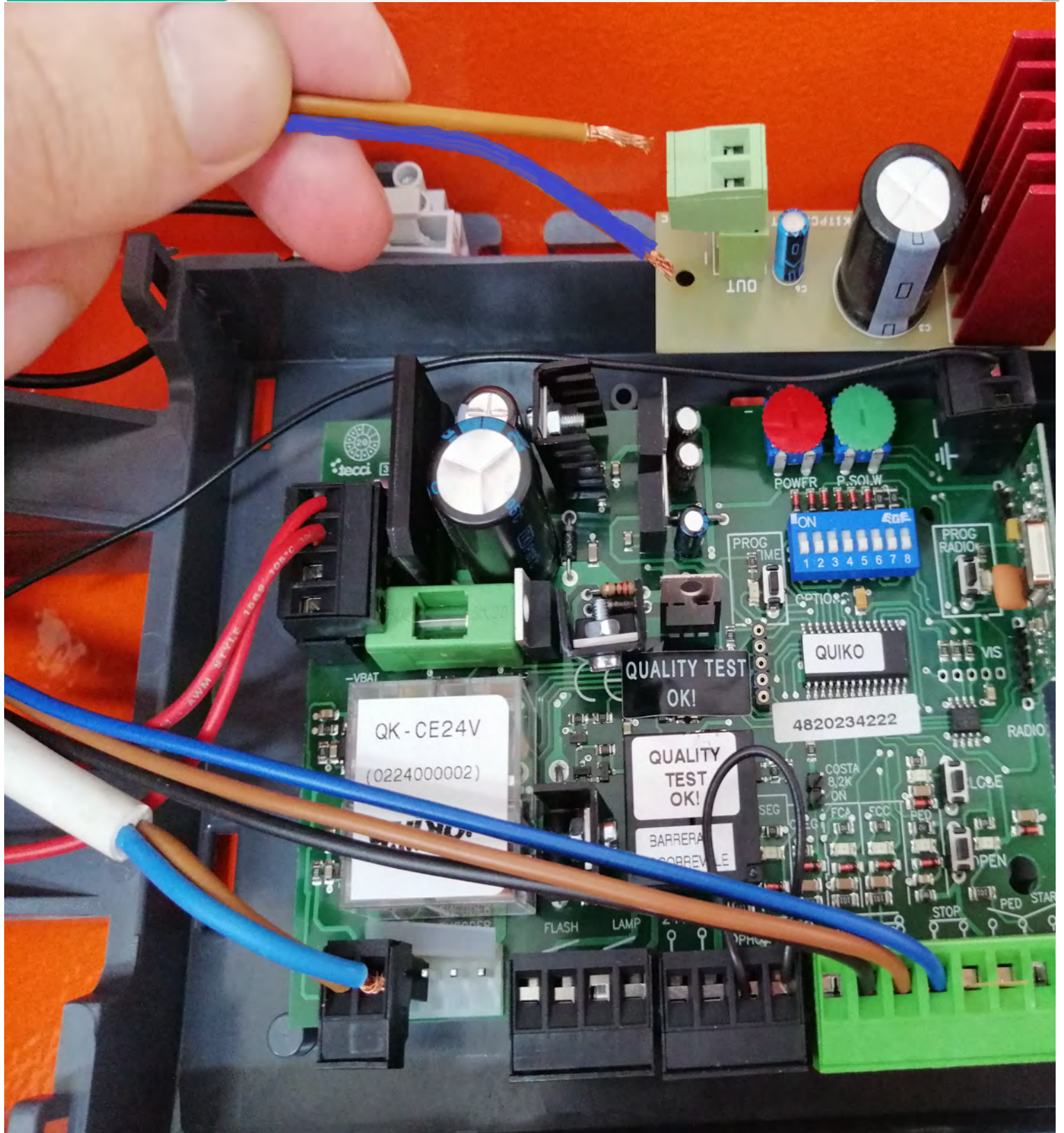

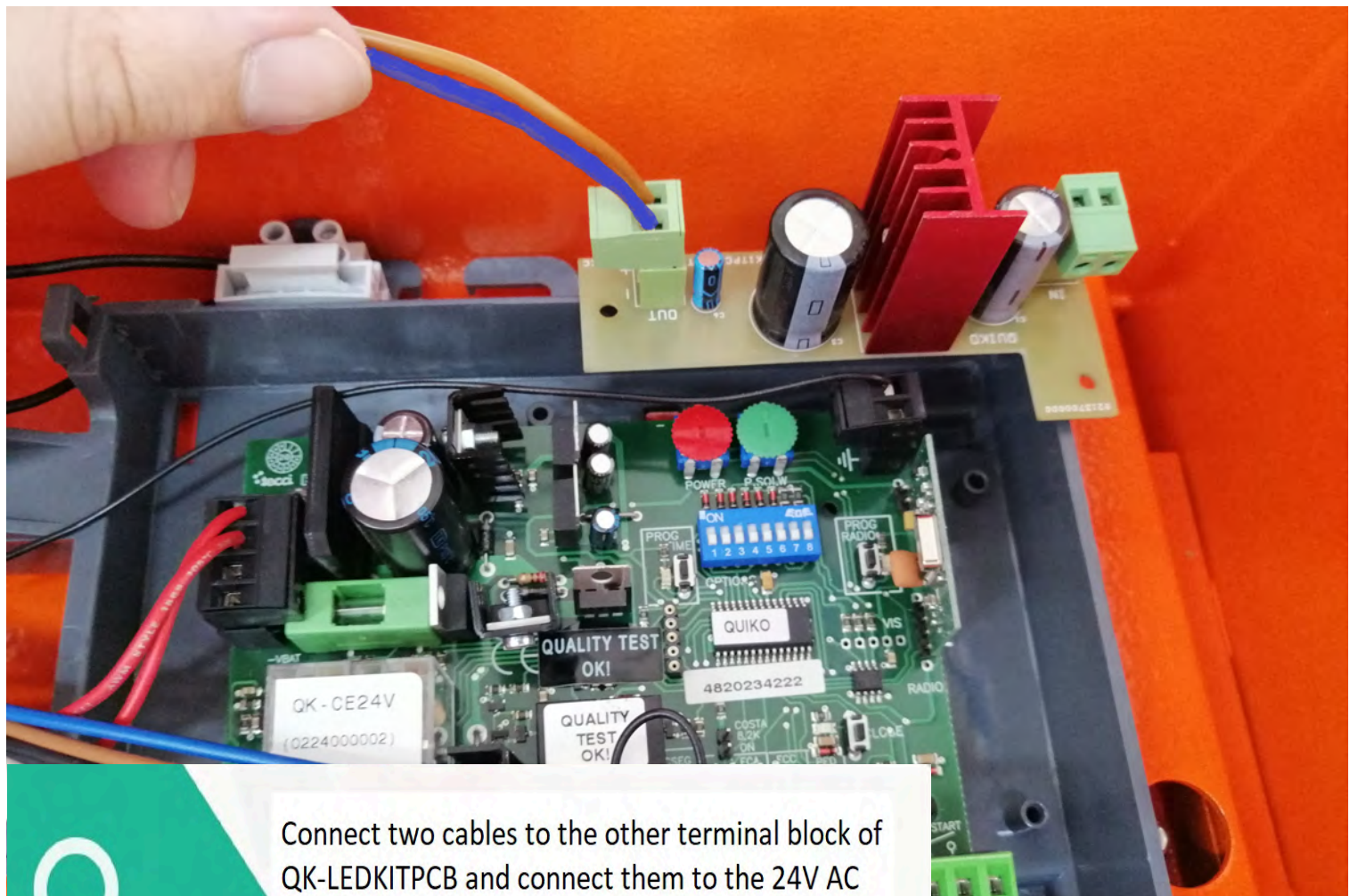

Connect two cables to the other terminal block of QK-LEDKITPCB and connect them to the 24V AC terminals n.23 and n.24 of the control board, as shown on the following pictures.

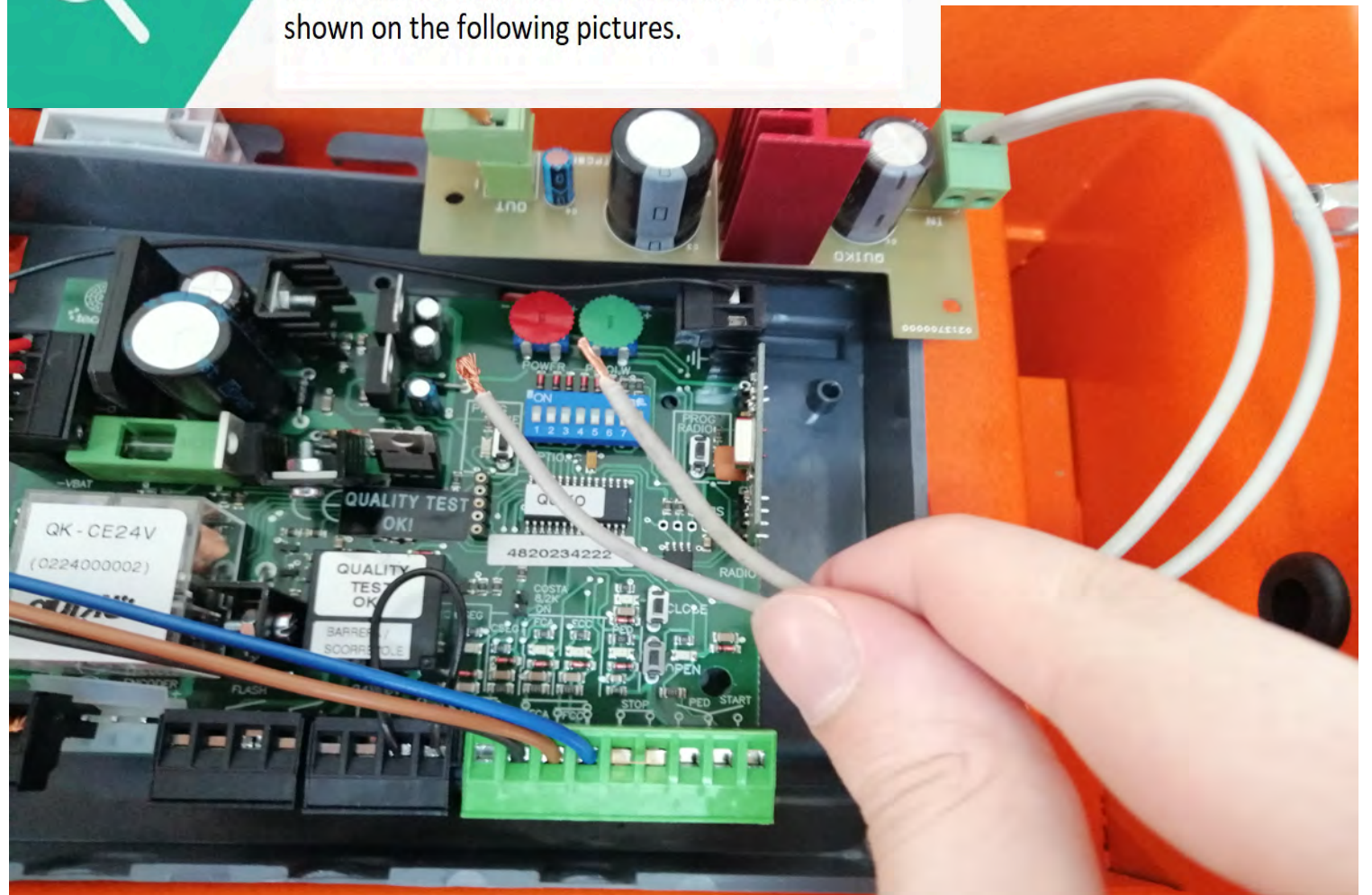

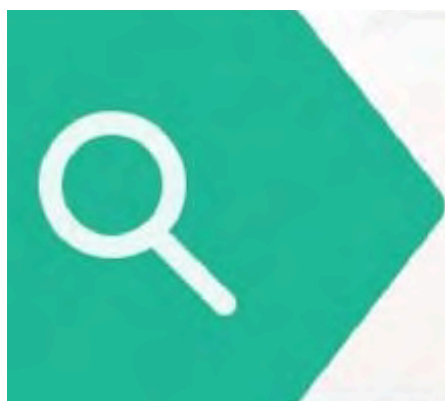
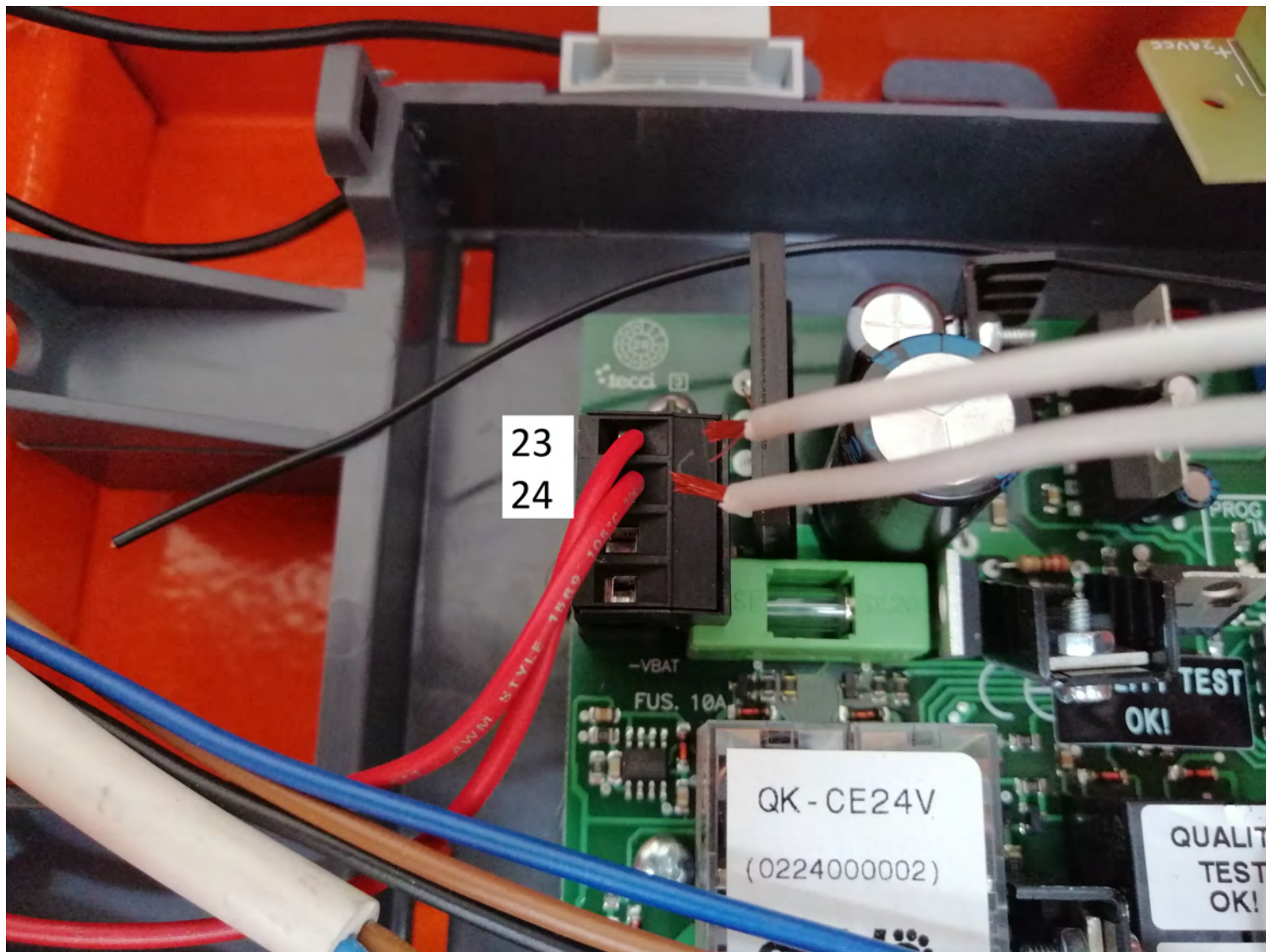

In the picture above you can see a close-up of the terminal block in which you need to connect the QK-LEDKITPCB cables. Please refer to the manual of QK-CE24V if you need help finding input pins n.23 and n.24.



Setup completed. Now switch on the automatic barrier system and the LED tube will flash approximately every 0.8 seconds.

Once installation is completed, finalise fixing of the gray metal support of barrier arm with all other bolts and nuts not fixed previously.

## DECLARATION OF CONFORMITY

(OF THE MANUFACTURER)



**Manufacturer: QUIKO ITALY SAS**

Via Seccalegno, 19  
36040 Sossano (VI)  
Italia

hereby declares, under his liability, that products:  
QK-LEDKIT3, QK-LEDKIT4, QK-LEDKIT5, QK-LEDKIT6

are in compliance with the essential safety requirements of the regulations:

- ✓ Electro-magnetic Compatibility Directive .....2004/108/EC
- ✓ Low Voltage Directive .....2006/95/EC
- ✓ Machinery Directive .....2006/42/EC

and their amendments and modifications, and with the regulations set forth by the National Legislative Body of the country in which the machinery is destined for use.

Sossano, 26/01/2017

Managing Director  
Luca Borinato







**QUIKO ITALY**

Via Seccalegno, 19  
36040 Sossano (VI) - Italy  
Tel. +39 0444 785513  
Fax +39 0444 782371  
**info@quiko.biz**  
**www.quikoitaly.com**



*The Manufacturer can technically improve  
the quality of its products without  
any prior notice.*