

Lightblade

QK-LEDKIT

High Visibility Neon Effect Lighting System for ICARUS series Automatic Barriers

E
N
G
L
I
S
H

QK-LEDKIT4 for 3-4m barriers
QK-LEDKIT5 for 5-6m barriers



IMPORTANT NOTICE:

Depending on the control board model supplied with your barrier, you might need to order QK-LEDKITPCB optional device separately.

Barriers equipped with new QK-CE24A control board have built-in LED light control system so they don't require QK-LEDKITPCB.

Barriers equipped with old QK-CE24V control board require optional QK-LEDKITPCB LED light control system.

quiö[®]
opening solutions

use and maintenance manual

The system can be installed on brand new or pre-existing automatic barriers of QUIKO of ICARUS serie

Contents of the kit:

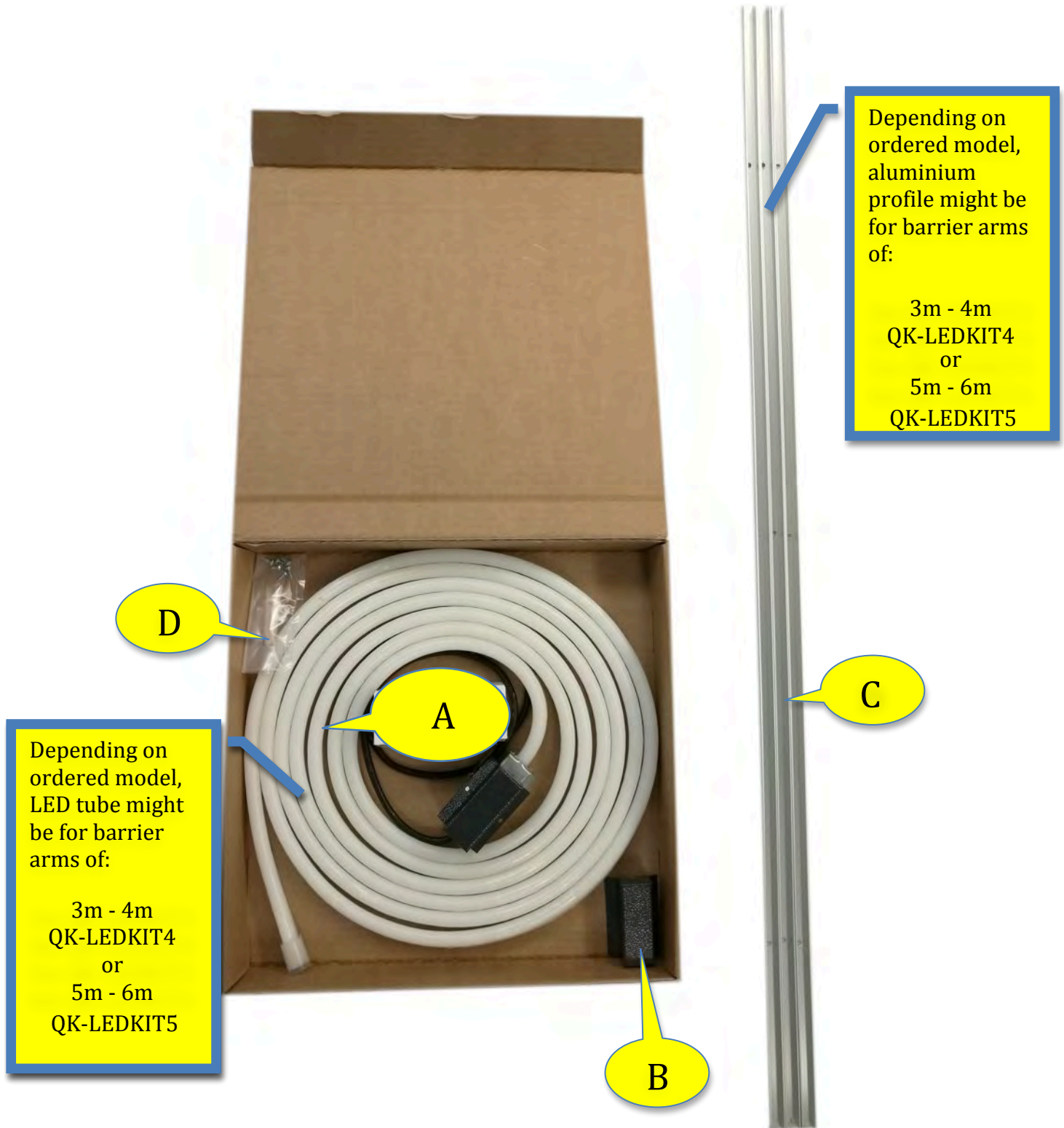

- A : 24V NEON EFFECT LED TUBE FOR 3-4-5-6m BARRIERS
- B : METAL COVER FOR NEON EFFECT LED TUBE
- C : ALUMINUM PROFILE FOR 3-4-5-6m BARRIERS
- D : SET OF FIXING SCREWS

IMPORTANT NOTICE:

Depending on the control board model supplied with your barrier, you might need to order QK-LEDKITPCB optional device separately. Barriers equipped with new QK-CE24A control board have built-in LED light control system so they don't require QK-LEDKITPCB. Barriers equipped with old QK-CE24V control board require optional QK-LEDKITPCB LED light control system.



Following procedure
is for barrier arms
going down on the
left side. For other
side please select
opposite holes.

quikö
MADE IN ITALY



Remove Rubber cap
from barrier housing

okinö
MADE IN ITALY







By means of scissors, cut it inside so to allow passage of LED power supply cable

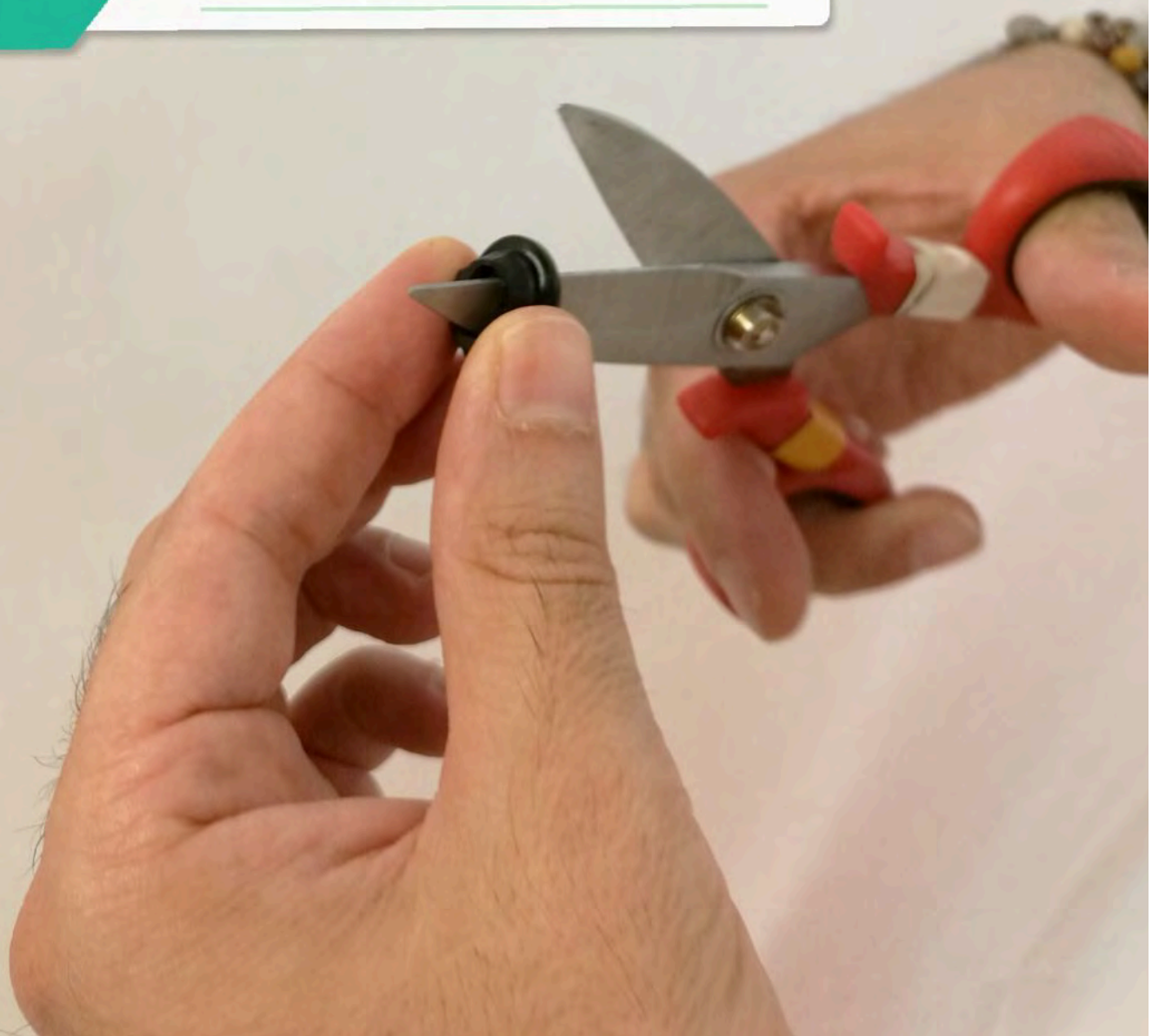





Re-position the rubber cap in its position within barrier metal housing



QUIKO
MADE IN ITALY



Get the LED tube
ready for installation





Pay attention on
handling LED tube with
care

Bending LED
tube like in the
picture won't
damage the
product

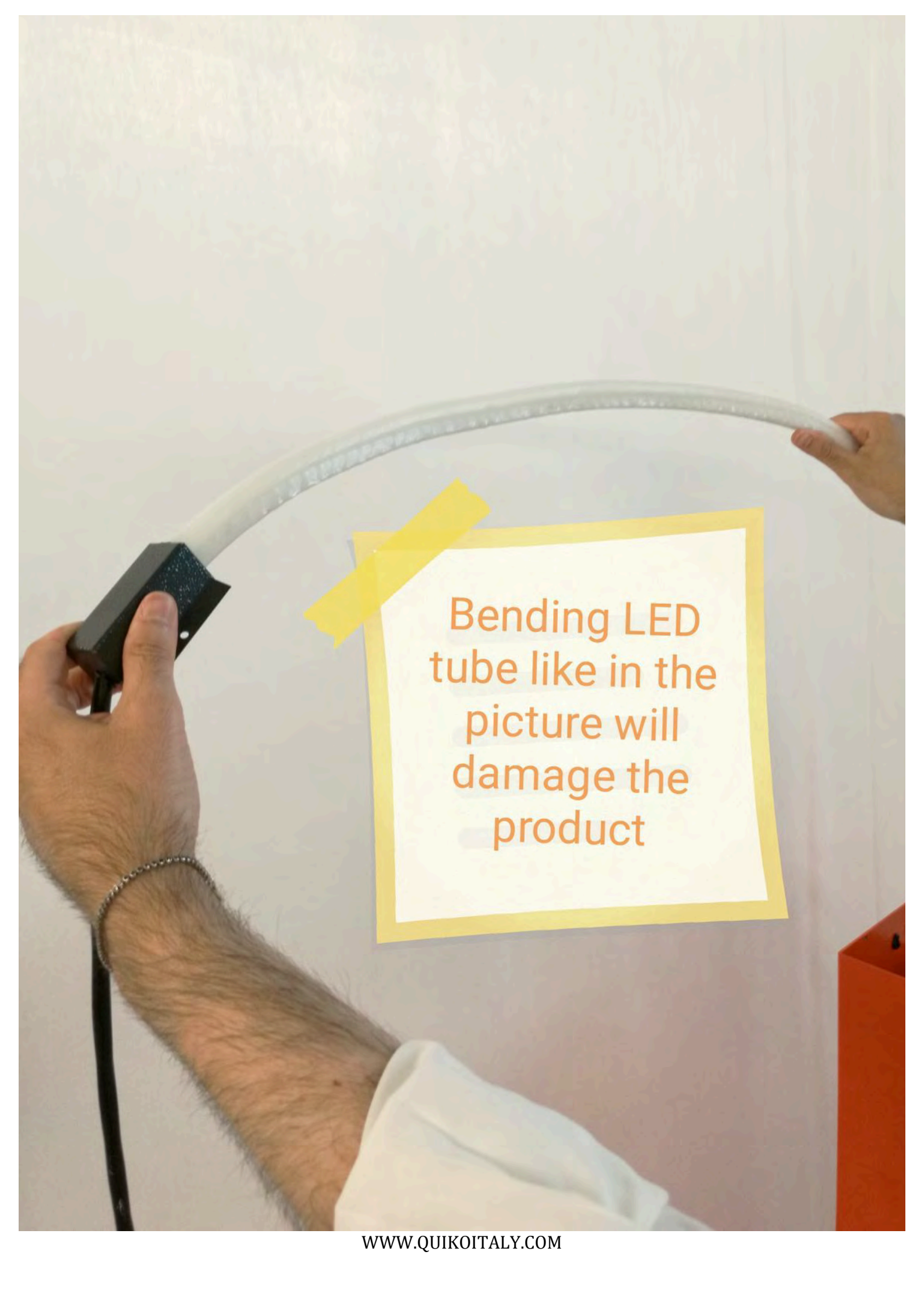
A person is using a heat gun to bend a white LED tube. The tube is held in a curved shape. A yellow-bordered text box is overlaid on the image, containing a warning message. The background is a plain, light-colored wall.

Bending LED
tube like in the
picture will
damage the
product



Pass power supply
cable of LED tube through
hole shown on picture



Leave about 25cm of cable on the other side as shown on picture



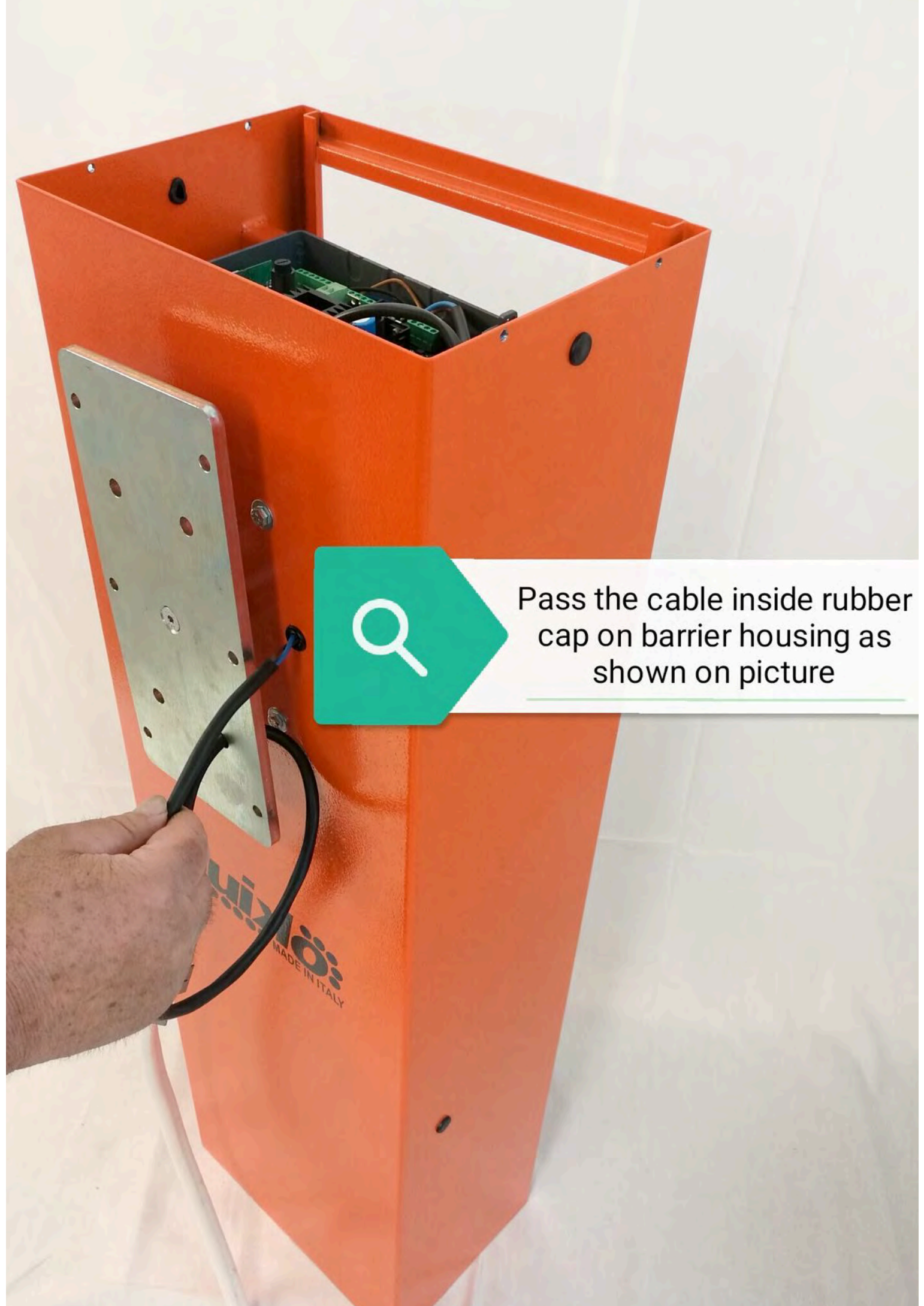

Pass the cable inside rubber cap on barrier housing as shown on picture

MADE IN ITALY

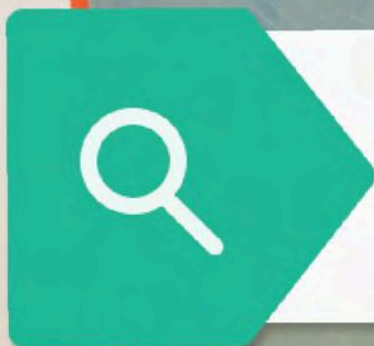

Leave extra cable between barrier housing and barrier arm metal plate, as this will be needed when the arm goes down

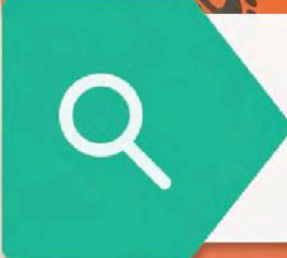
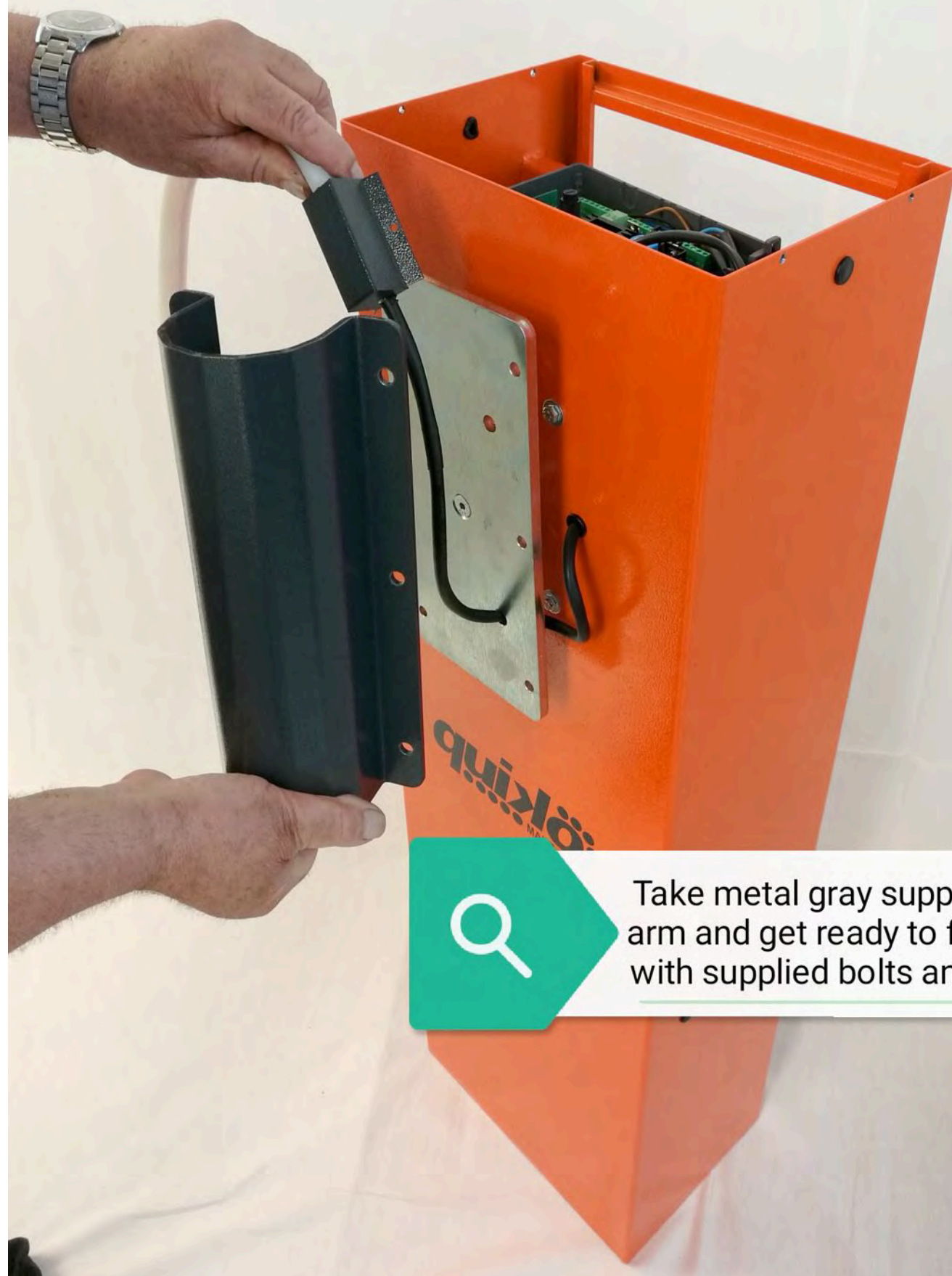

Take metal gray support for arm and get ready to fix it with supplied bolts and nuts

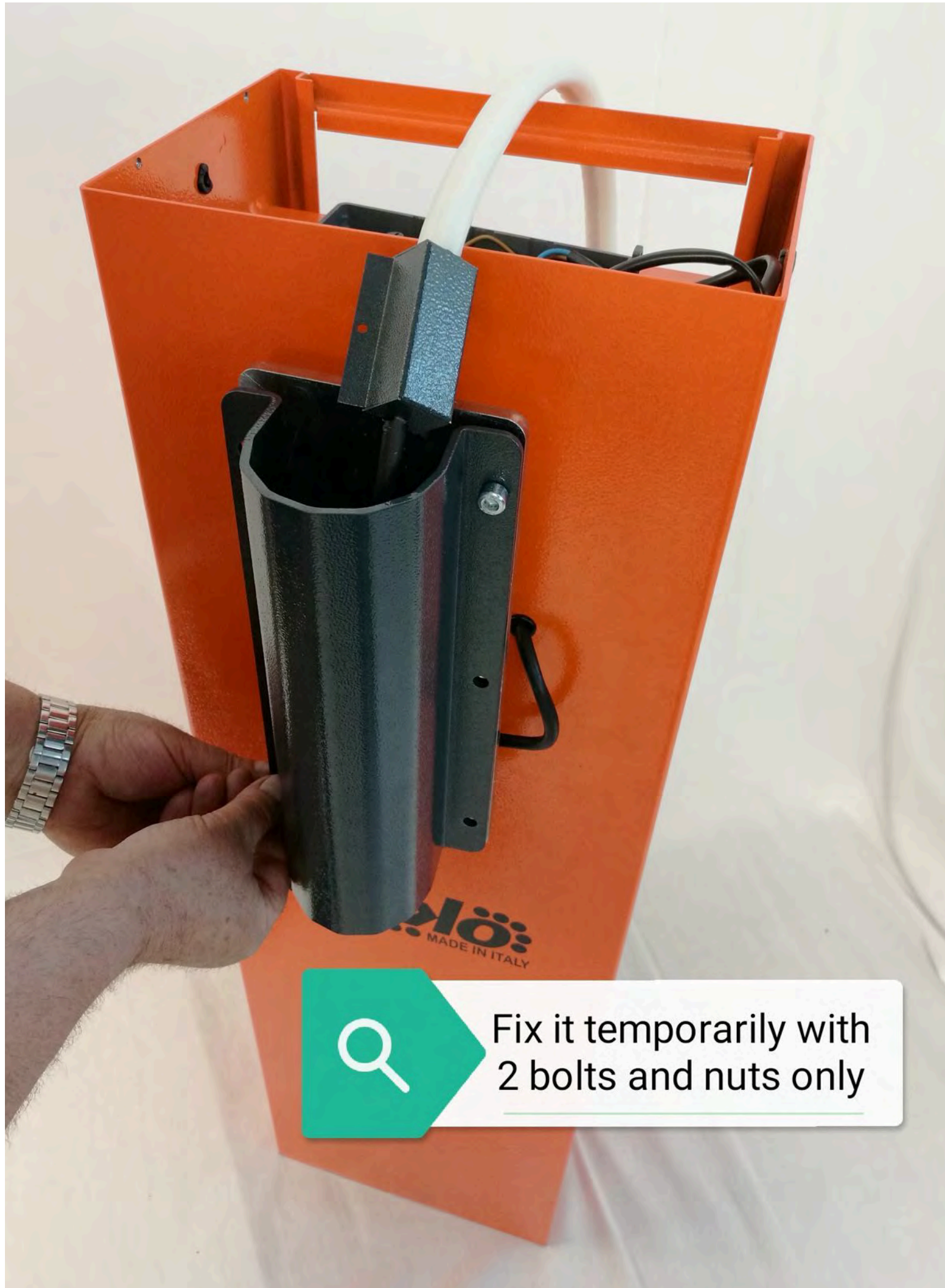

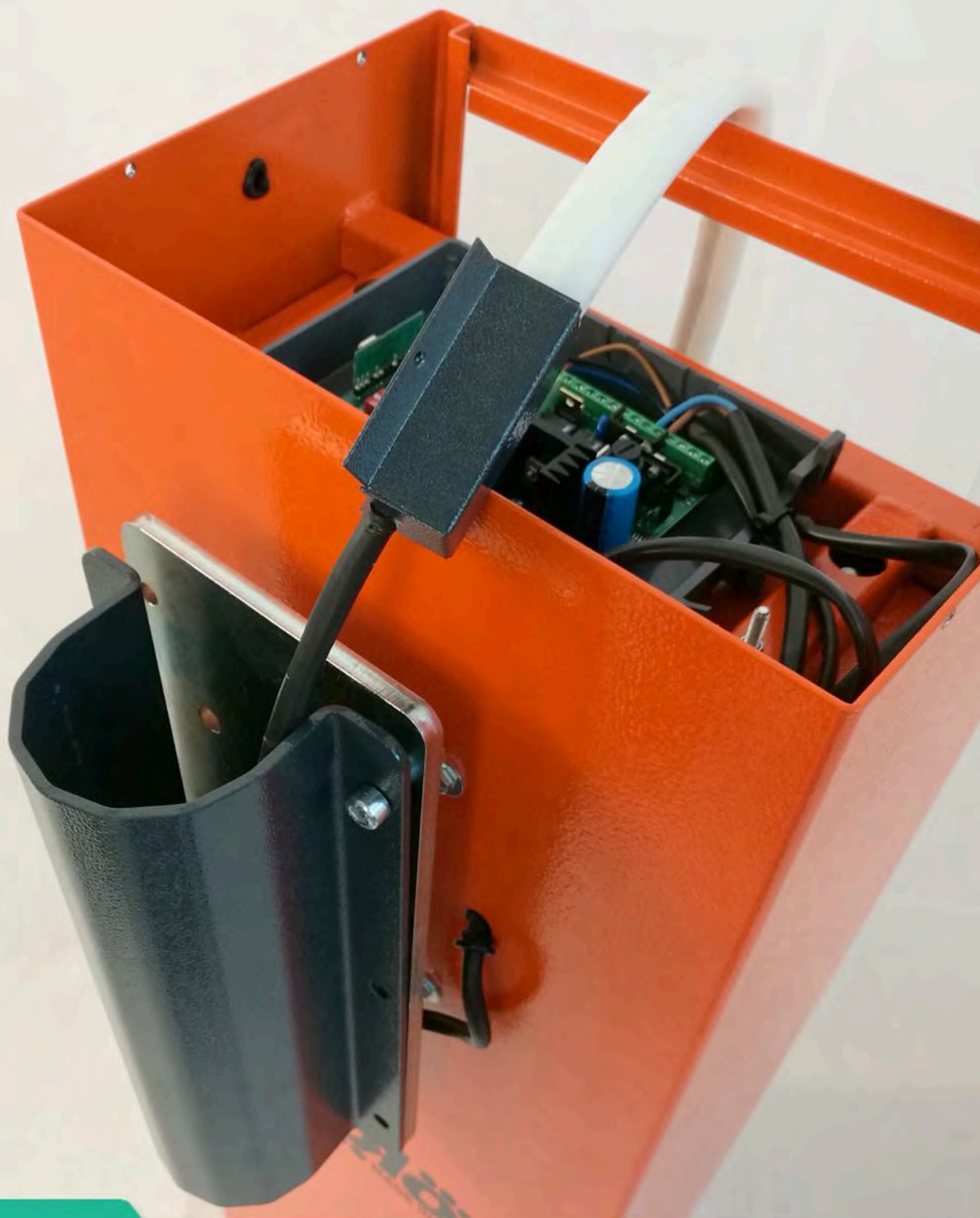

Hold LED tube power supply cable on right side of arm support as shown on picture

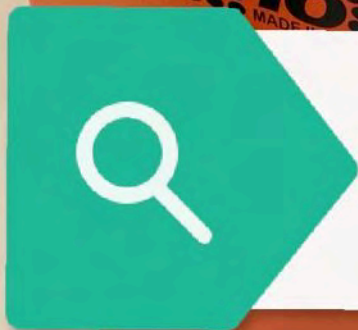

Insert barrier
arm

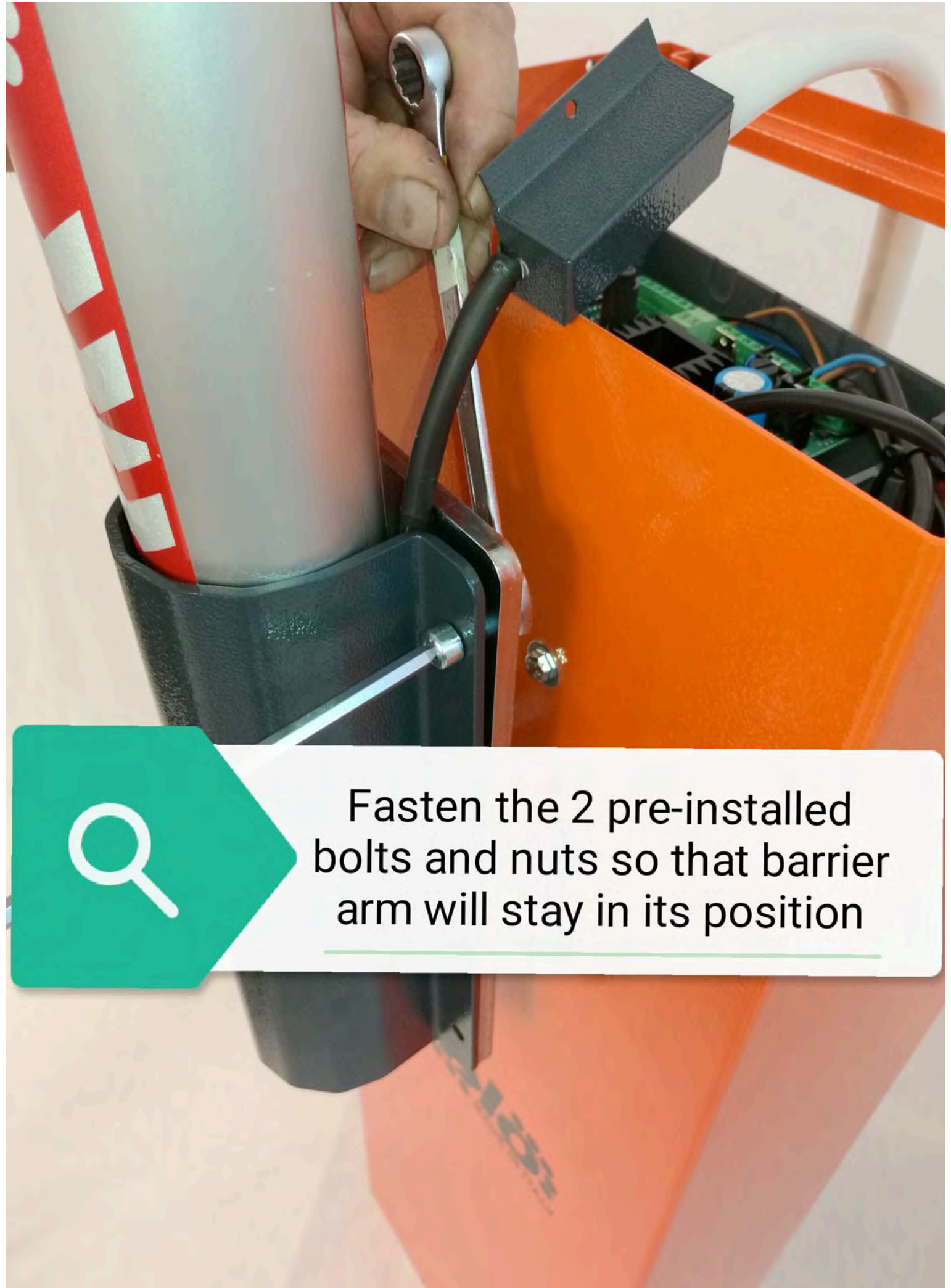

Fasten the 2 pre-installed bolts and nuts so that barrier arm will stay in its position

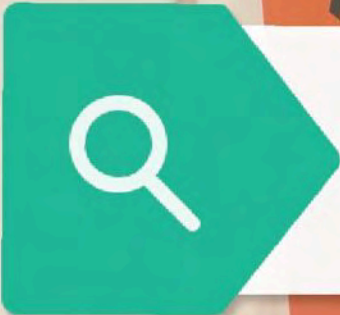
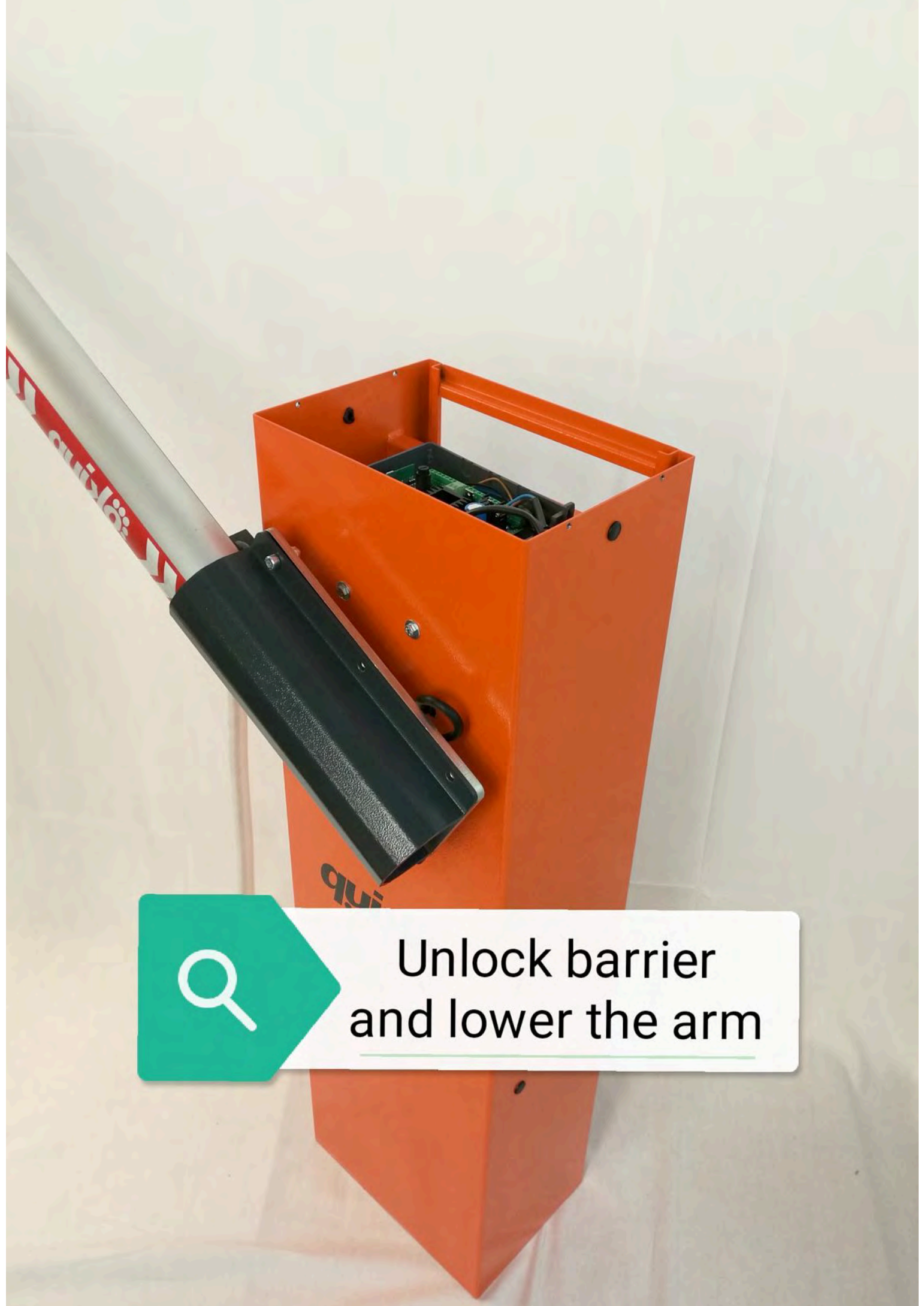

Unlock barrier
and lower the arm



Position the gray metal cover of LED tube in the center of aluminum arm as shown on picture





Drill first hole

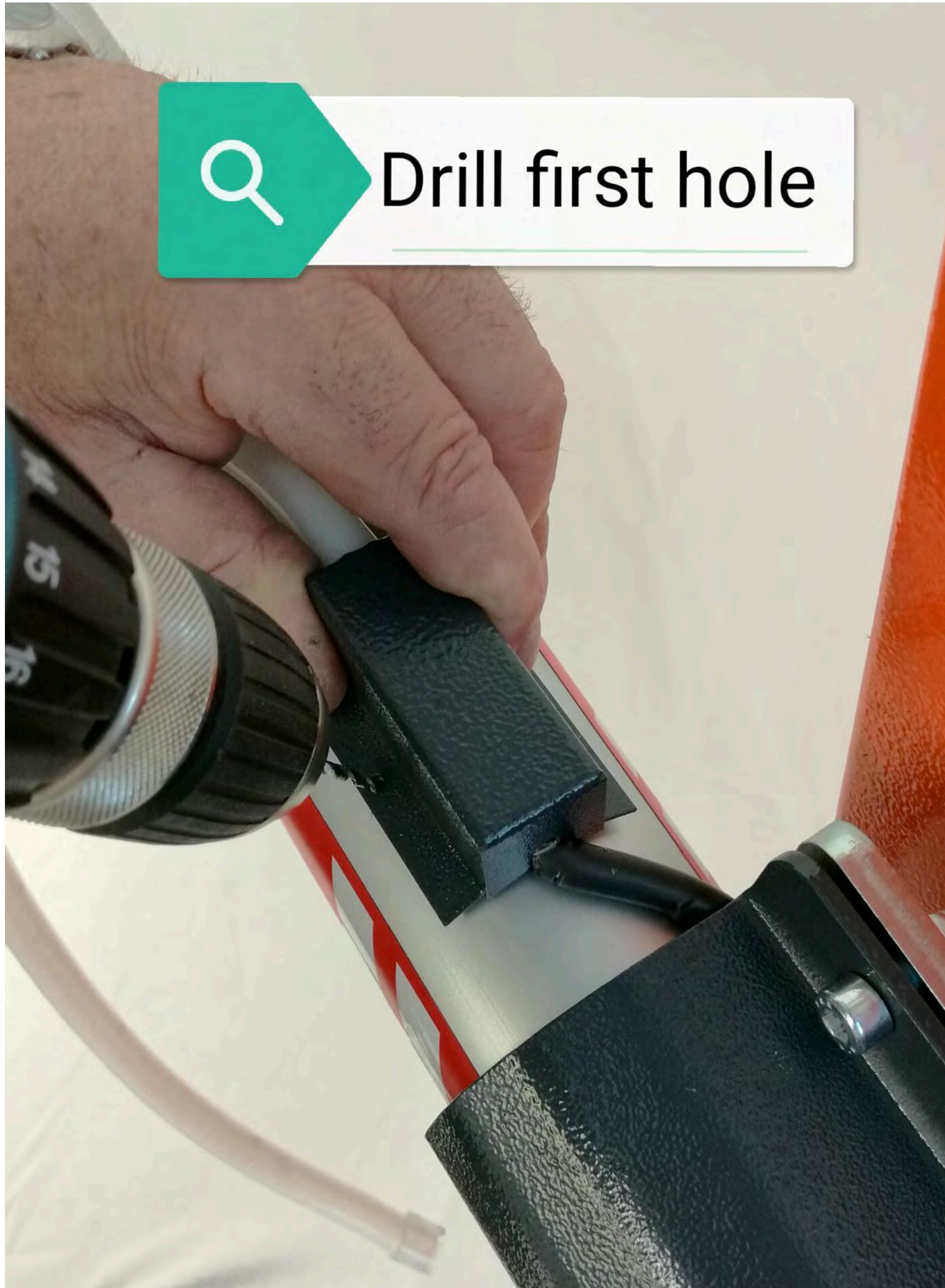



Position and fasten first fixing screw



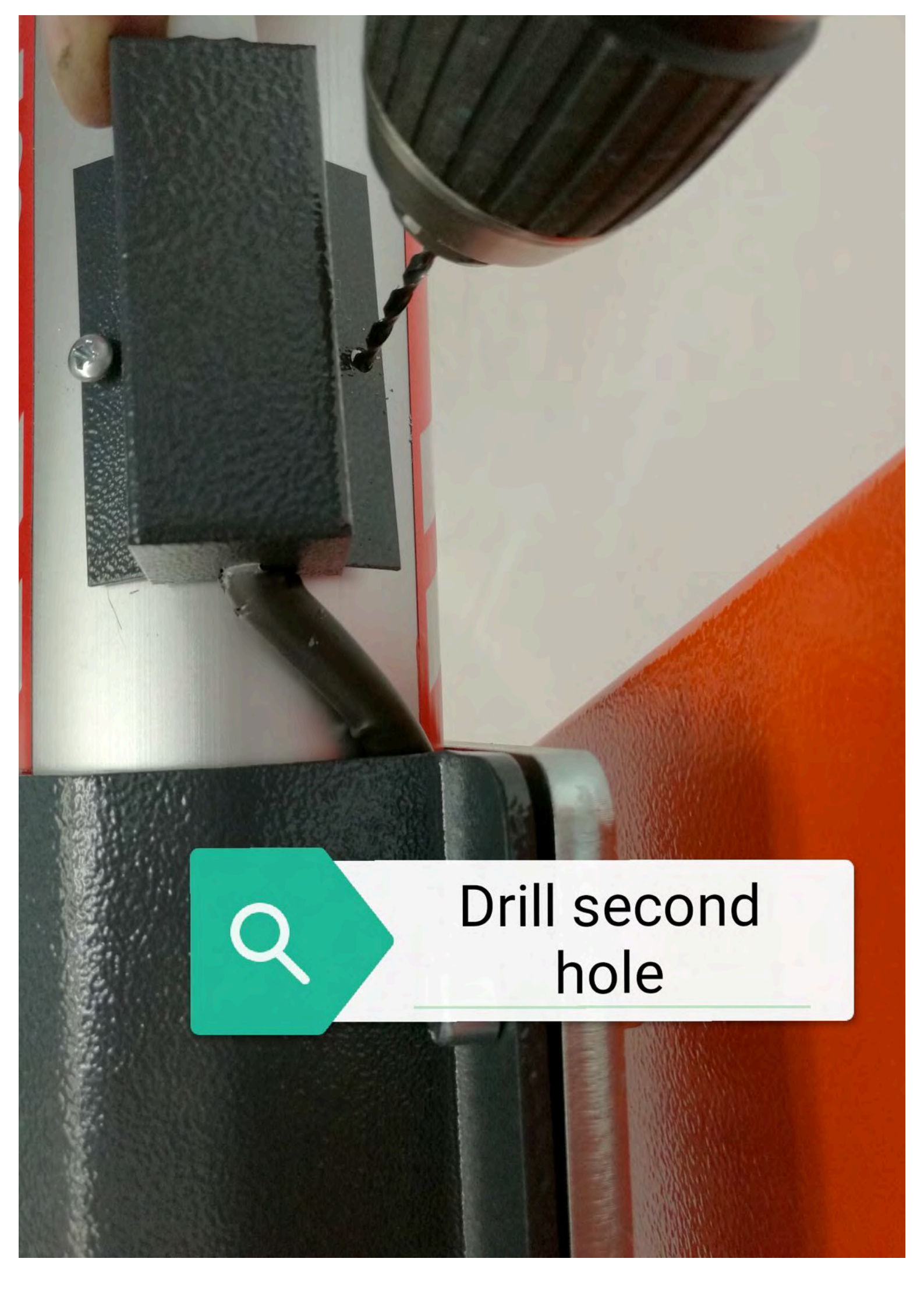

Drill second
hole



Position and fasten
second fixing screw



Position the supplied aluminium profile for LED tube on barrier arm as shown on picture



Depending on the length of the LED tube kit you have purchased, you have to fix 3-4-5-6 meters of aluminium profile. Each piece of aluminium profile is 1m

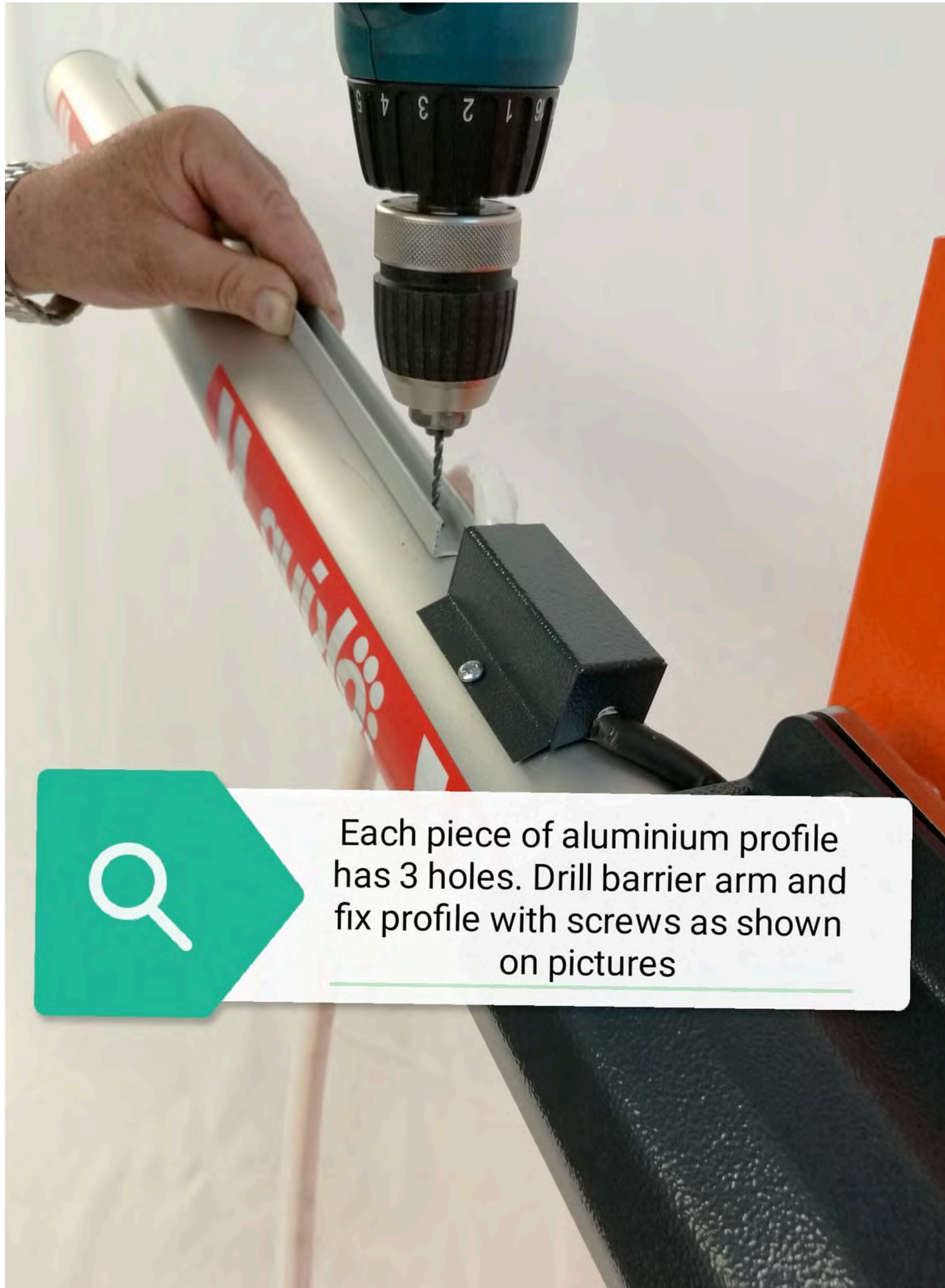

Each piece of aluminium profile has 3 holes. Drill barrier arm and fix profile with screws as shown on pictures



Insert LED tube within
aluminium profile as
shown on pictures

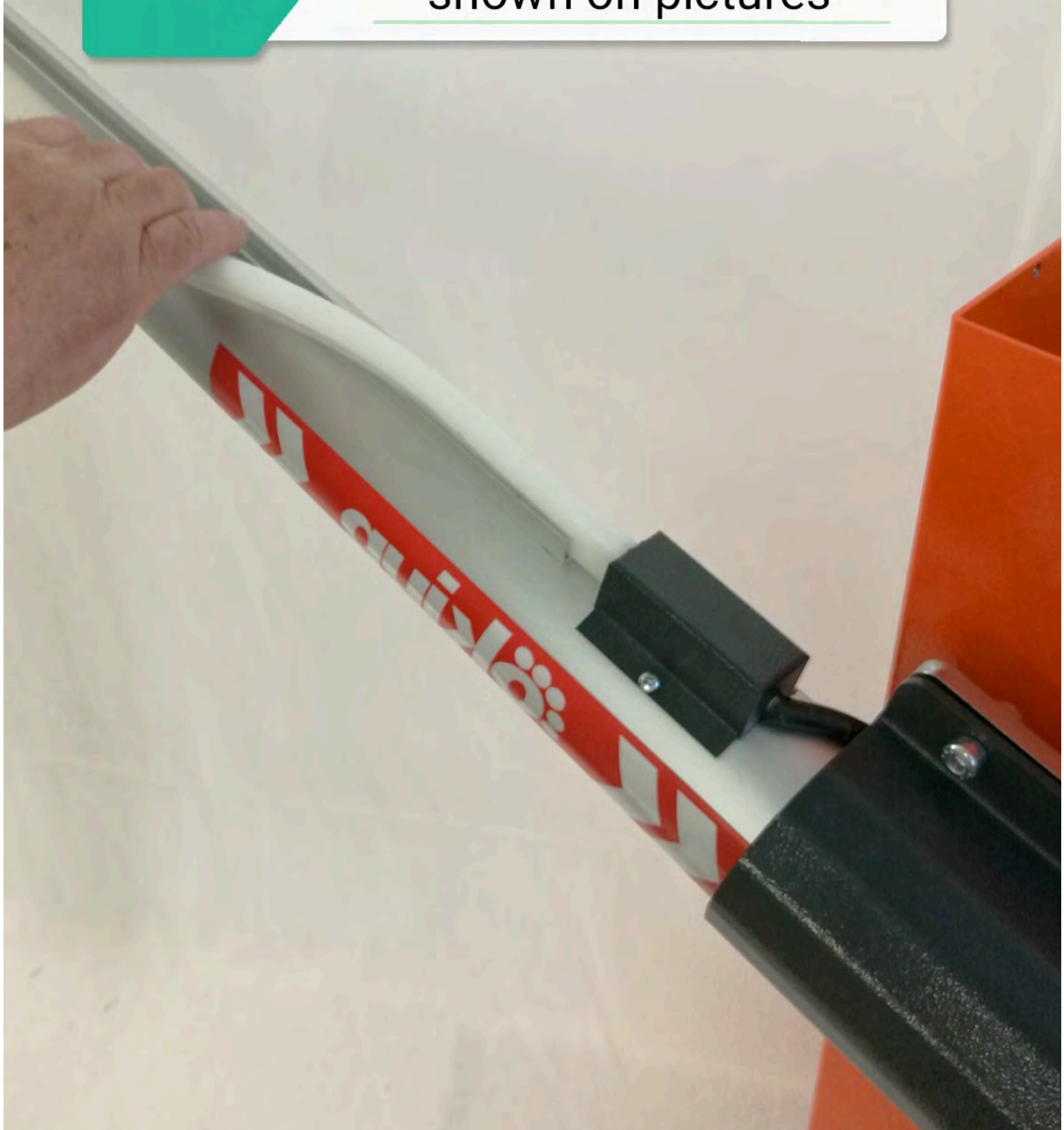



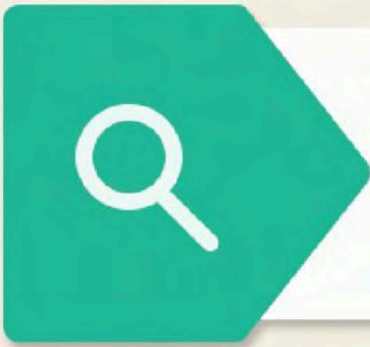

Place metal cover protection
on last part of LED tube as
shown on pictures



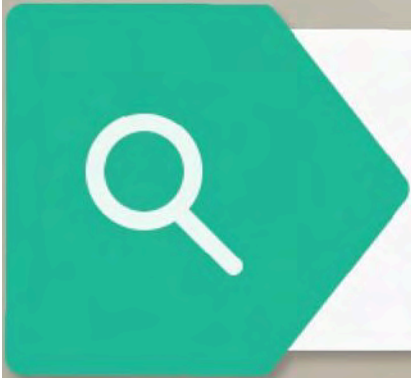
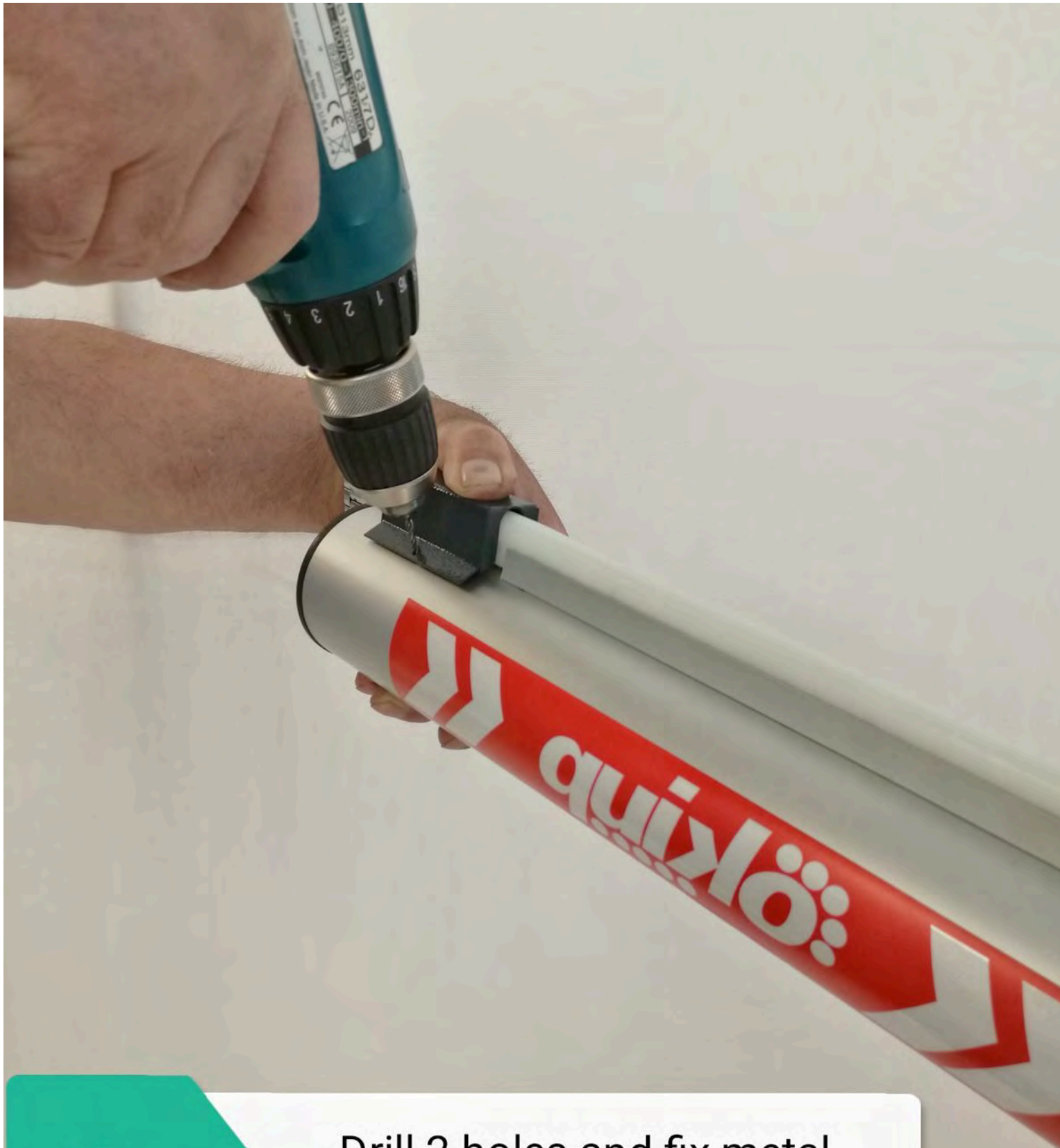

Drill 2 holes and fix metal
cover protection with screws
as shown on pictures









Take LED tube power supply cable and pass it through the apposite space so to reach the upper control board compartment

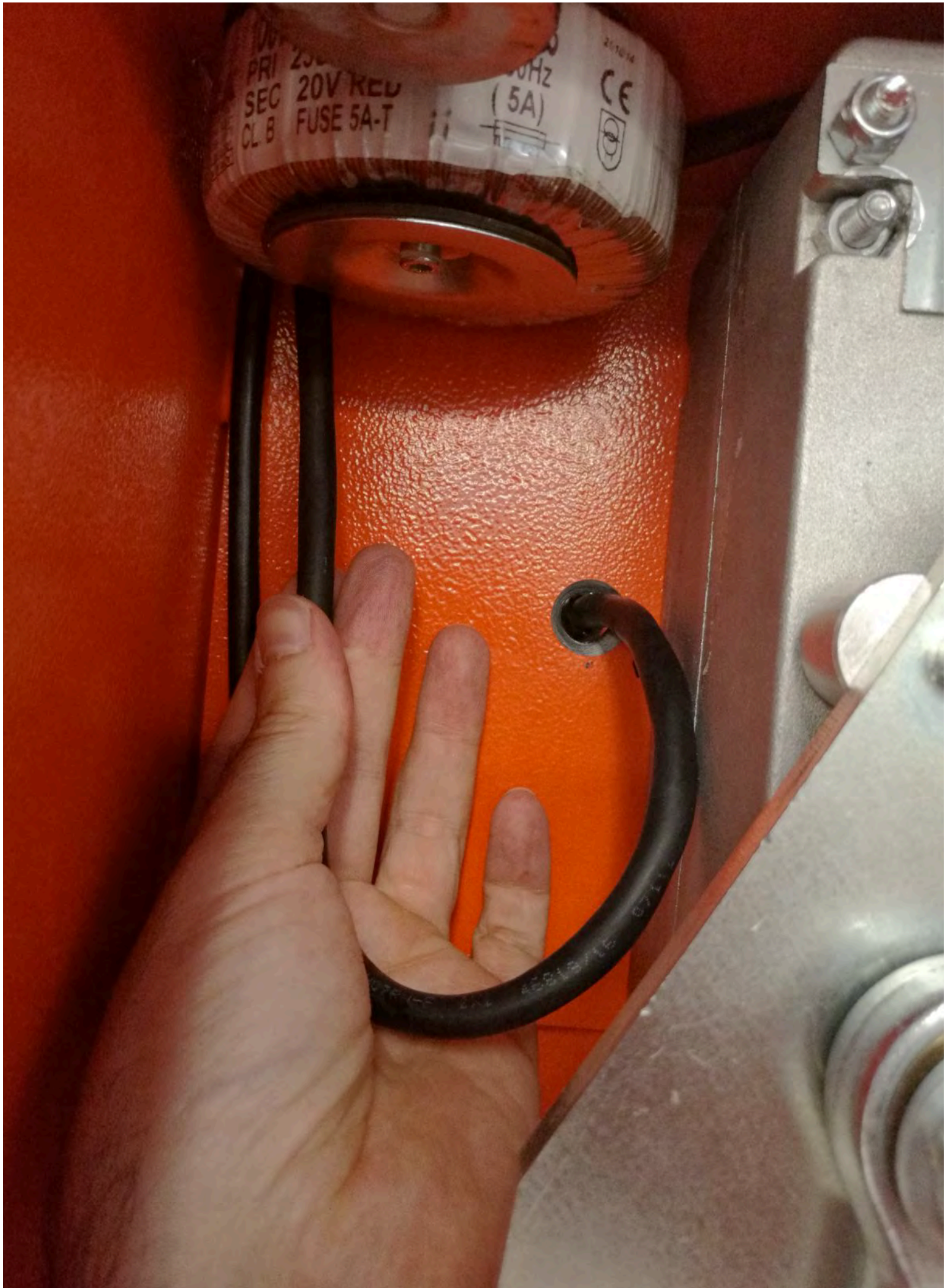

CONNECTION TO QK-CE24A CONTROL BOARD

NOTE: QK-LEDKITPCB is NOT needed to perform this connection

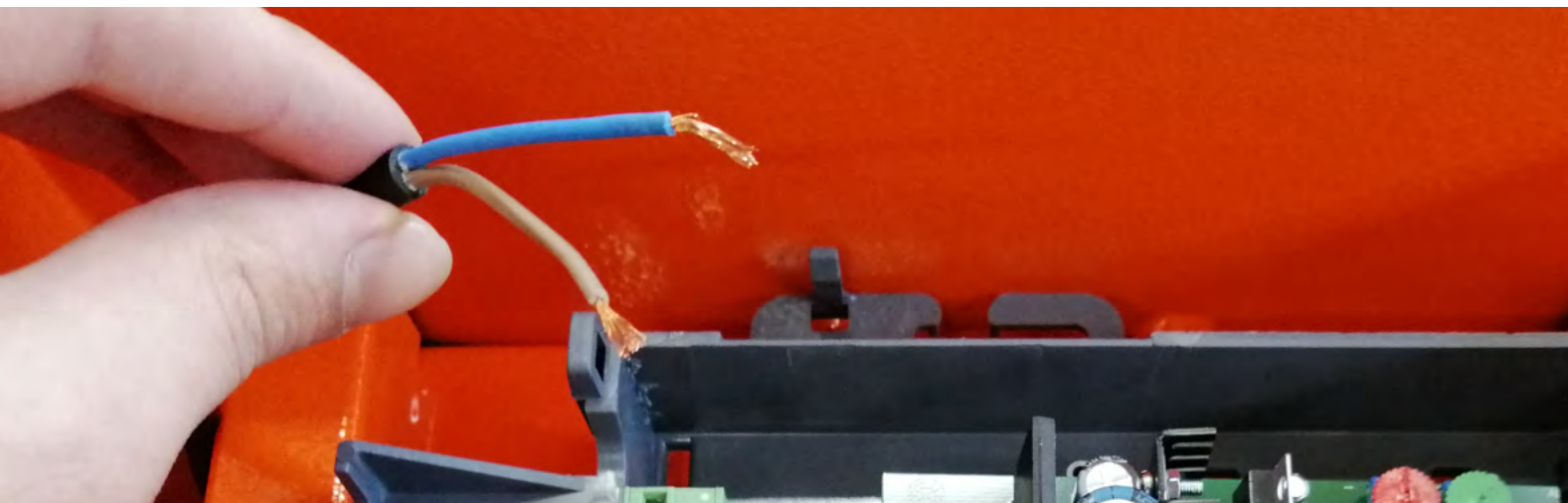

Now extract the LEDKIT Cable from the apposite hole on the top left corner of the barrier and get ready to connect the LEDKIT to the control board.

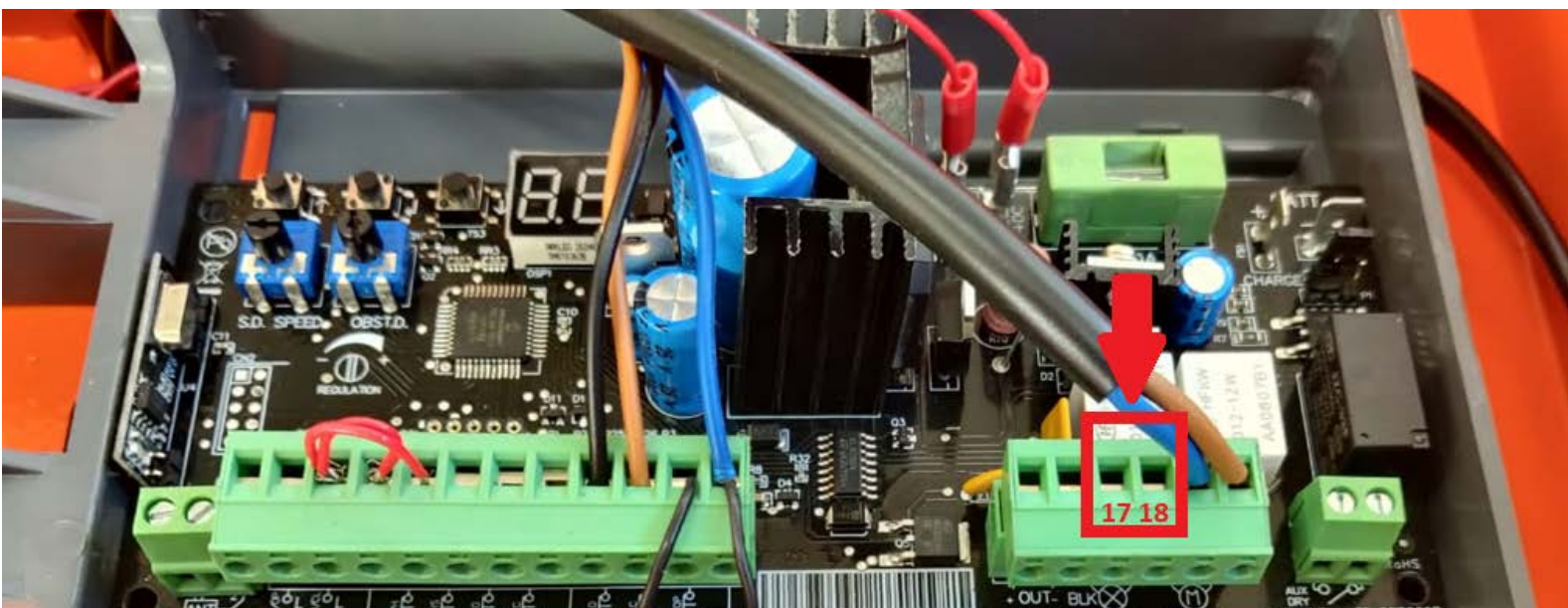

Connect the QK-LEDKIT cables to the QK-CE24A control board terminals n. 17 (positive - brown cable) and 18 (negative - blue cable) shown in the RED BOX in the above photo.

Setup completed.

Now you only need to switch on the automatic barrier system and select the desired flashing mode by means of the "bL" function of the QK-CE24A control board.

Below you can find the possible choices.

bL Blinker flashing mode:

Enabling this function, the blinker output flashes itself without needs of external flashing board. Use up/down to choose yes (Y) for flashing, not (N) for fixed light blinker or exit (E). Push enter to confirm.

L1 (for QK-LEDKIT) Slow flash when the boom is in stand-by; Fast flash while it's moving

L2 (for QK-LEDKIT) Fixed light when the boom is in stand-by; Fast flash while it's moving

ATTENTION:

Once installation is completed, finalise fixing of the gray metal support of barrier arm with all other bolts and nuts not fixed previously.

IMPORTANT NOTICE:

Depending on the control board model supplied with your barrier, you might need to order QK-LEDKITPCB optional device separately. Barriers equipped with new QK-CE24A control board have built-in LED light control system so they don't require QK-LEDKITPCB. Barriers equipped with old QK-CE24V control board require optional QK-LEDKITPCB LED light control system.

CONNECTION TO QK-CE24V CONTROL BOARD

NOTE: QK-LEDKITPCB is needed to perform this connection



Now extract the LEDKIT Cable from the apposite hole on the top left corner of the barrier and get ready to connect the LEDKIT control card.



Take out LEDKITPCB from its box and connect the cables as shown on the next pages.

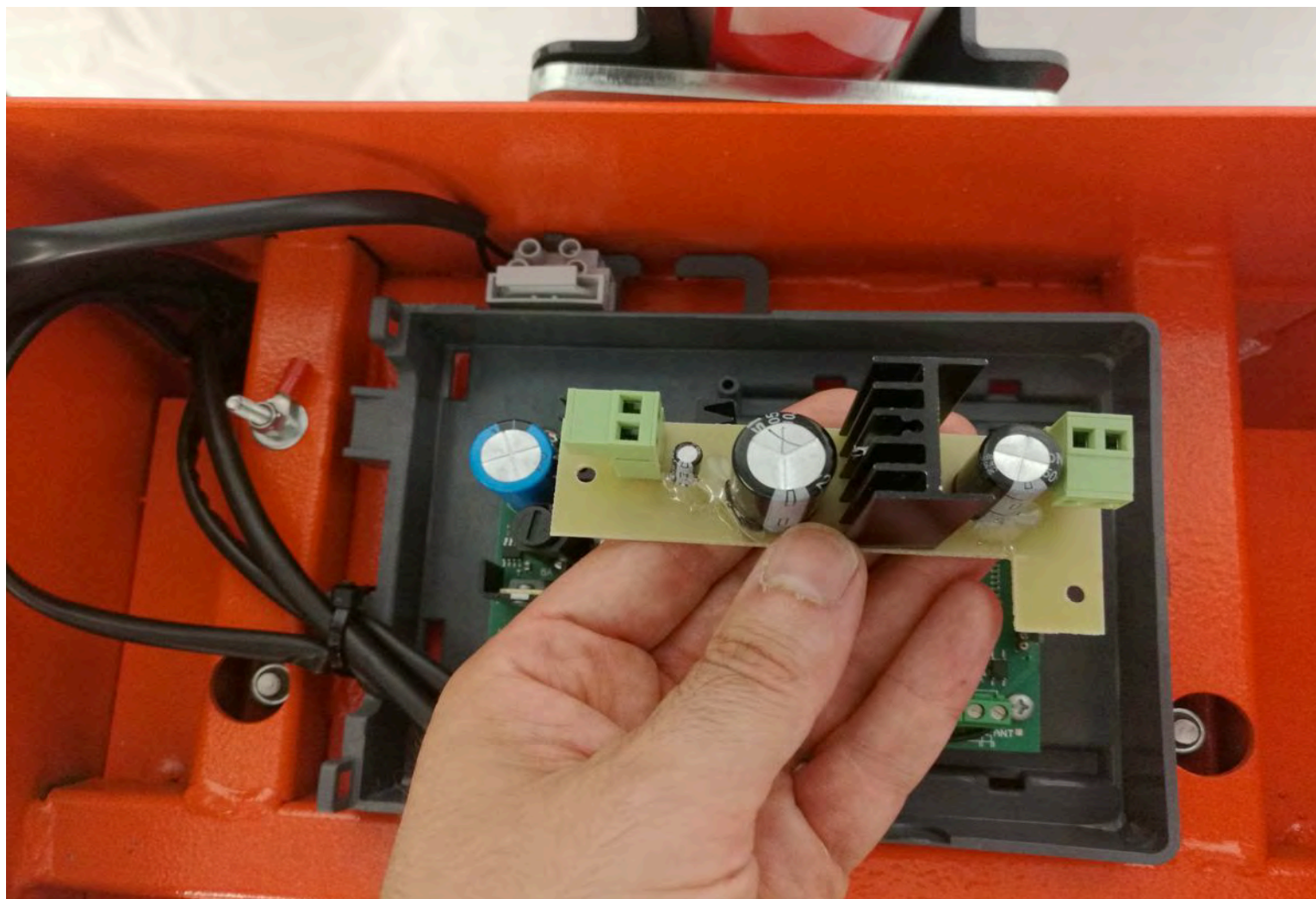



Connect LED tube power supply cable to apposite terminal block of QK-LEDKITPCB, respecting the polarity. Brown cable is (+), blue cable is (-).

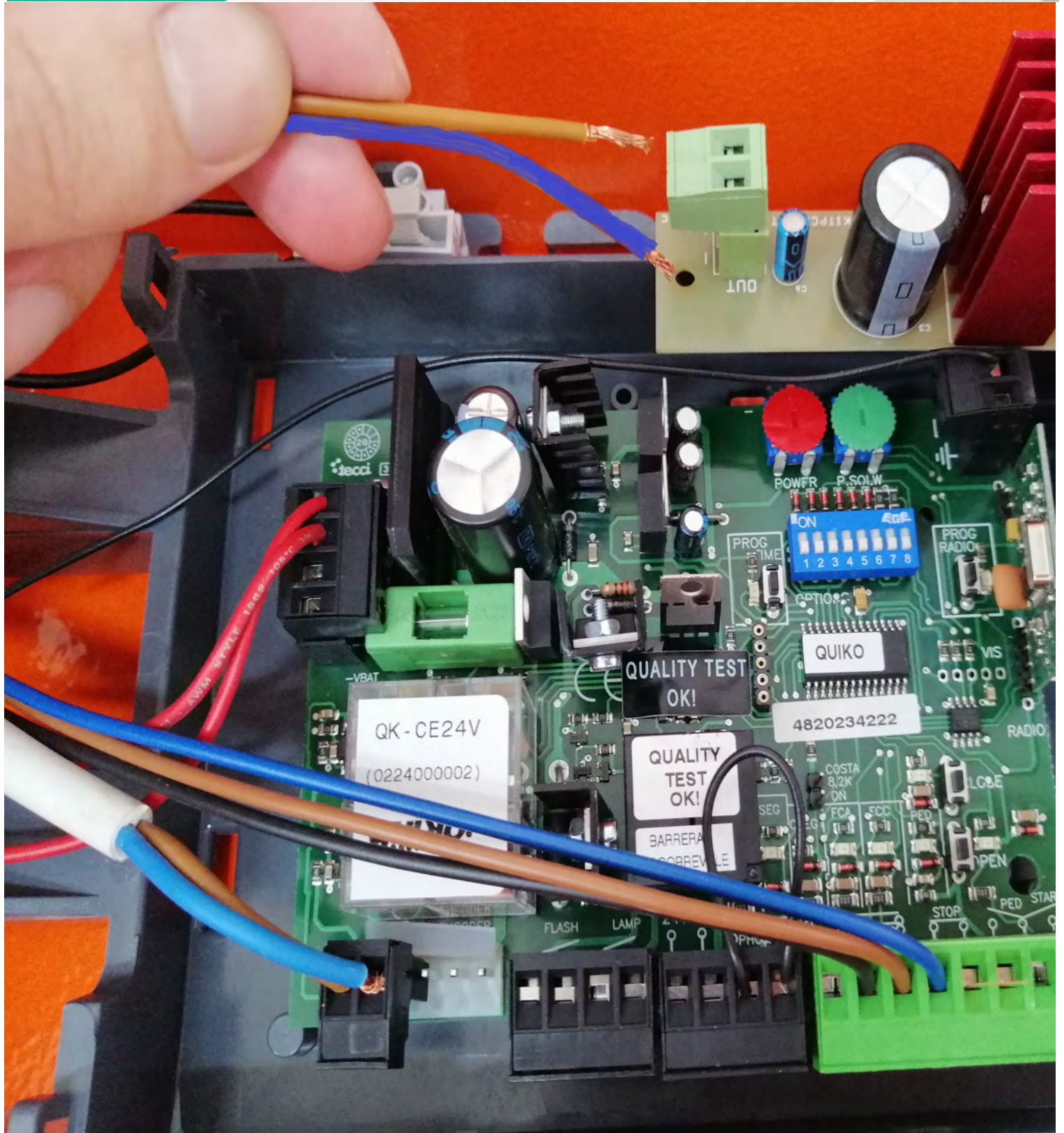

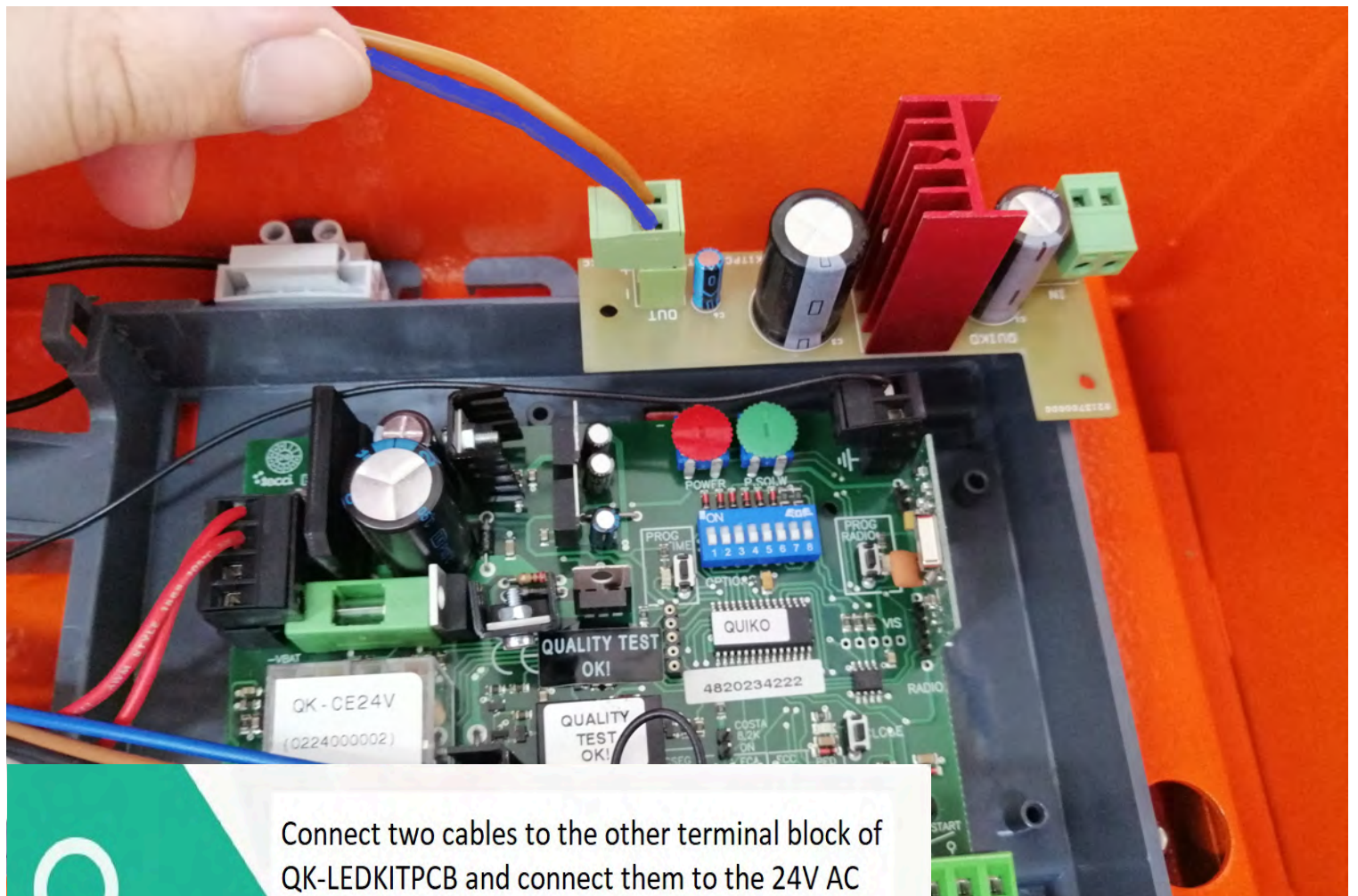

Connect two cables to the other terminal block of QK-LEDKITPCB and connect them to the 24V AC terminals n.23 and n.24 of the control board, as shown on the following pictures.

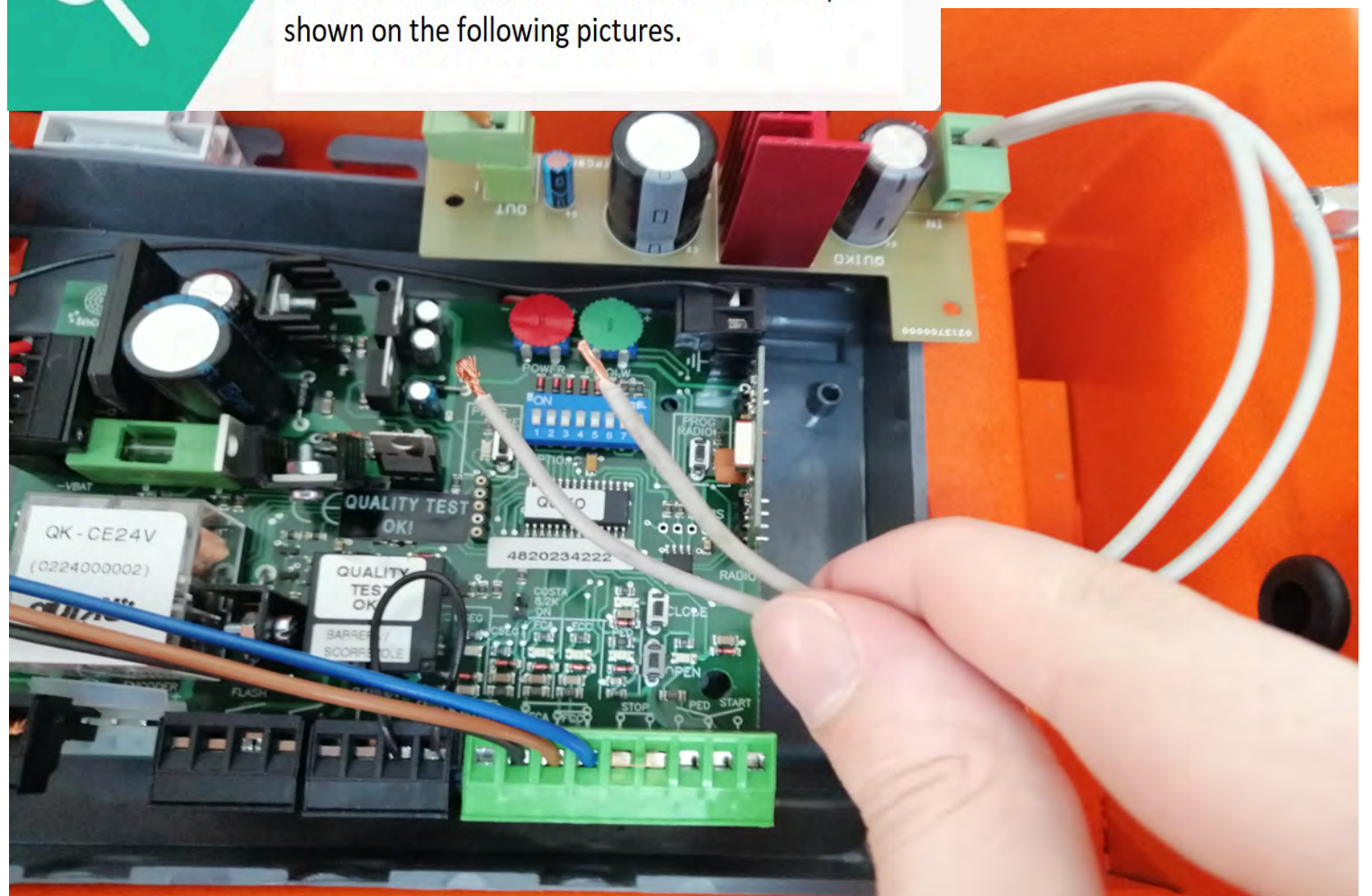

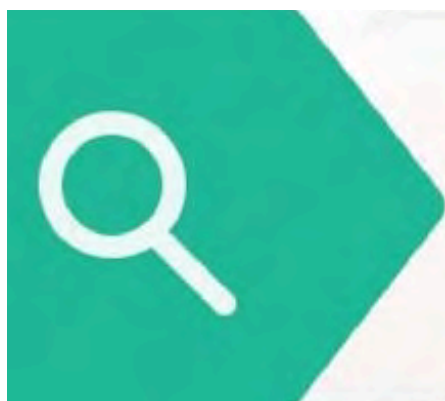
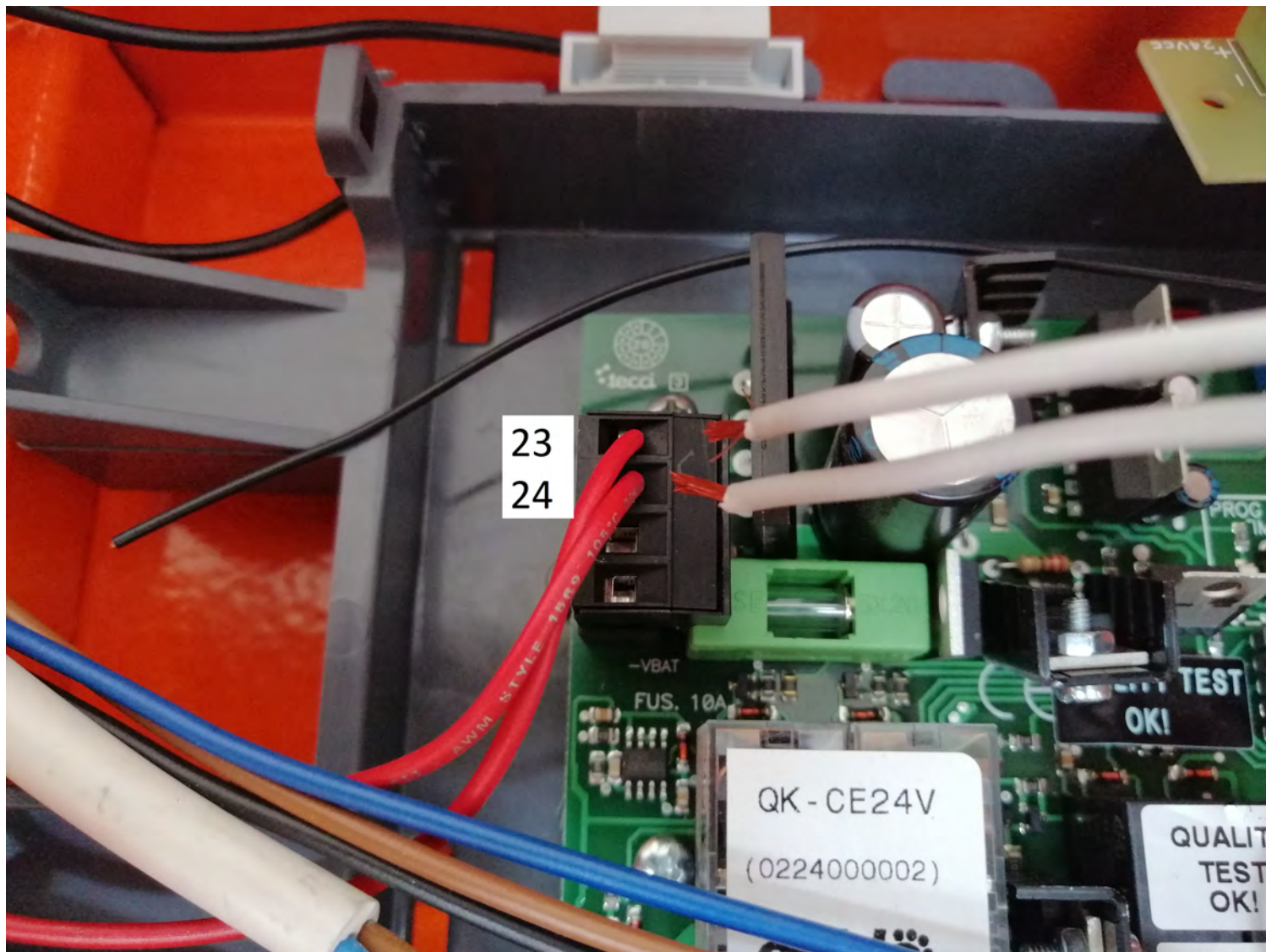

In the picture above you can see a close-up of the terminal block in which you need to connect the QK-LEDKITPCB cables. Please refer to the manual of QK-CE24V if you need help finding input pins n.23 and n.24.



Setup completed. Now switch on the automatic barrier system and the LED tube will flash approximately every 0.8 seconds.

ATTENTION:

Once installation is completed, finalise fixing of the gray metal support of barrier arm with all other bolts and nuts not fixed previously.

DECLARATION OF CONFORMITY

(OF THE MANUFACTURER)



Manufacturer: QUIKO ITALY SRL

Via Seccalegno, 19
36040 Sossano (VI)
Italia

hereby declares, under his liability, that products:
QK-LEDKIT4, QK-LEDKIT5

are in compliance with the essential safety requirements of the regulations:

- ✓ Electro-magnetic Compatibility Directive2004/108/EC
- ✓ Low Voltage Directive2006/95/EC
- ✓ Machinery Directive2006/42/EC

and their amendments and modifications, and with the regulations set forth by the National Legislative Body of the country in which the machinery is destined for use.

Sossano, 01/07/2022

Managing Director
Luca Borinato



QUIKO ITALY

Via Seccalegno, 19
36040 Sossano (VI) - Italy
Tel. +39 0444 785513
Fax +39 0444 782371
info@quikoitaly.com
www.quikoitaly.com



*The Manufacturer can technically improve
the quality of its products without
any prior notice.*