

QK - FRA_V02

FOLDING ROD ADAPTER



The folding rod adapter kit comprises the following elements:

1. Adjustable steel tie rod 8 mm diameter
2. Tie rod hinge assembly
3. articulation device

1. TIE ROD HINGE INSTALLATION

The tie rod hinge assembly consists of a galvanized square steel plate (125x125x4 mm) onto is welded the steel threaded bushing (diameter 20 mm).It has a reference hole see # A on the Fig. 2

To install the tie rod hinge on the articulated boom barrier proceed as follows:

- 1 Remove the rectangular plate # 1 (see Fig. 1)
- 2 unscrew the bolt # 2
- 3 Place the tie rod hinge assy. in such manner that the hole A is aligned to the hole of the bolt # 2
- 4 Temporary fasten the hinge assy. to the barrier cabinet with the bolt # 2
- 5 Keep the hinge assy. horizontal and drill (diameter 8 mm) the cabinet in correspondence of the other two holes.
(Fig. 3)
- 6 Fasten the plate to the cabinet with other two bolts M8
- 7 Reinstall the rectangular plate #1



Fig. 1 Barrier cabinet rear view

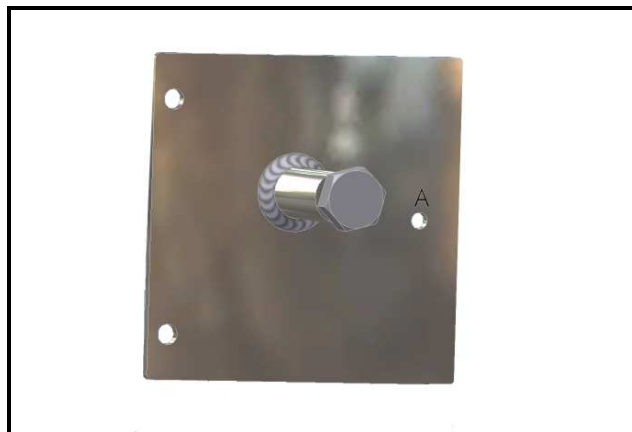

Fig. 2 Tie rod hinge assy.

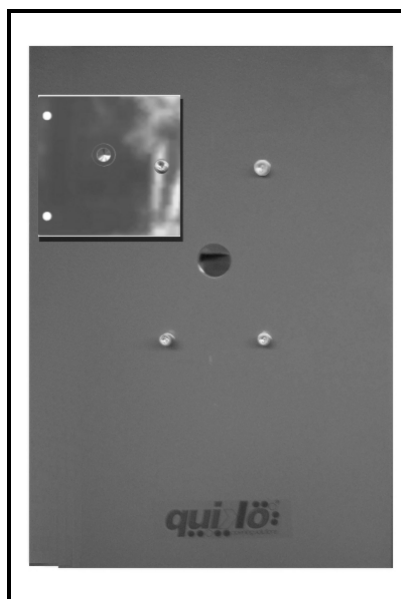
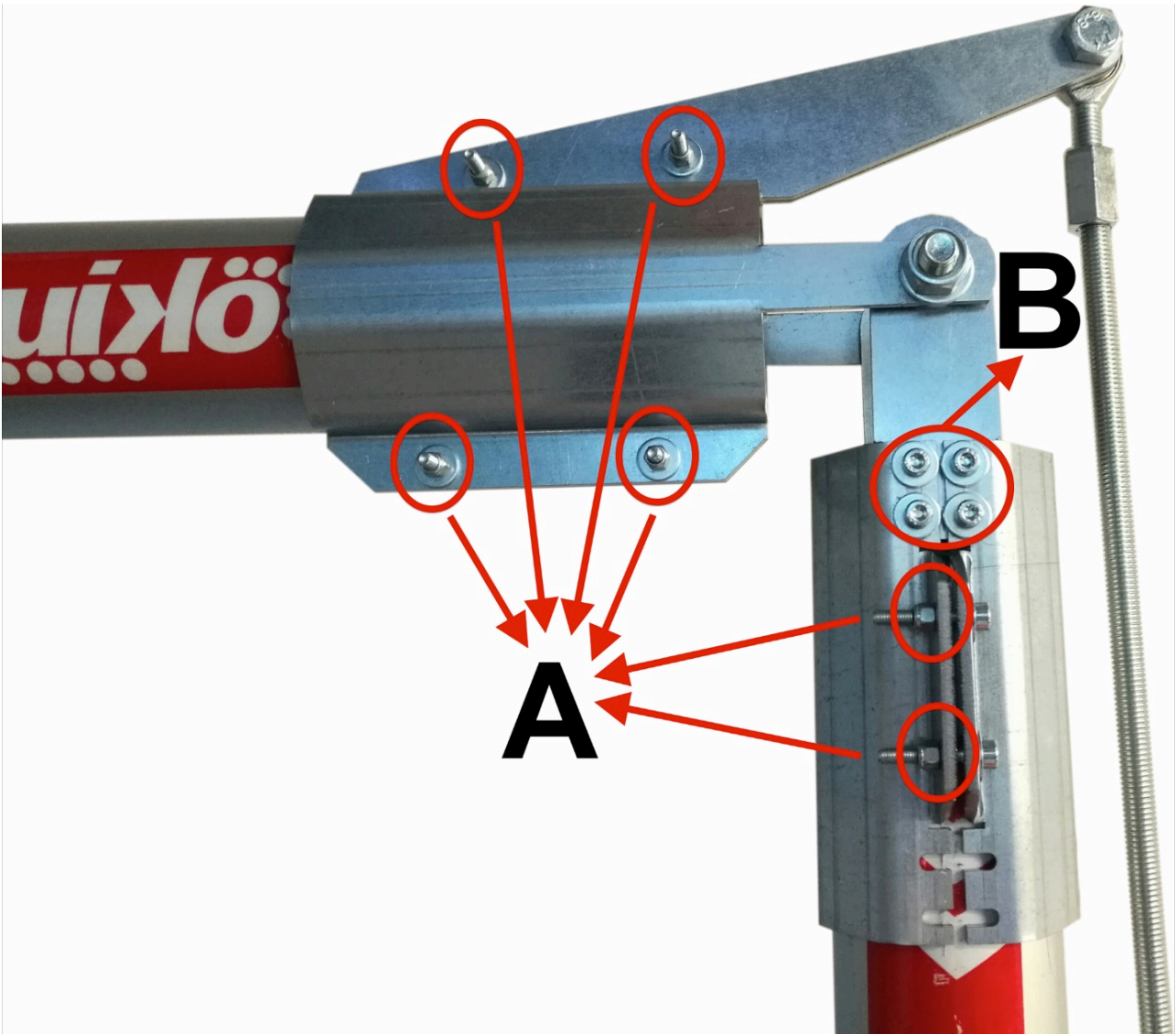

Fig. 3) Tie rod hinge fastened to the cabinet

2 – INSTALLATION OF THE ARTICULATION DEVICE



- cut the barrier arm at the desired length
- unloose A and B bolts partially
- insert the two cut arm pieces inside the articulation device
- fasten A bolts first and B bolts then
- check the proper functioning of the system and provide to give the right tensioning to the tie rod.

Keep away the hands from the tie rod hinge during the arm motion.