

Glass wing clamp profile with screws

Glass drilling heights

For realization of the wing using the clamp profile with screws, use only heat-strengthened glass measuring 10 or 12 mm and worked according to the drilling heights shown in the figures to the side.



Wing Weight ≤ 70 Kg



CAUTION

Do NOT use compound glass for realization of the wing when using the profile clamp with screws.



CAUTION

To calculate the weight of the glass wing, use the following formula:

Wing Weight (Kg) = 2.5 x glass dimension (in m²) x glass thickness (in mm)

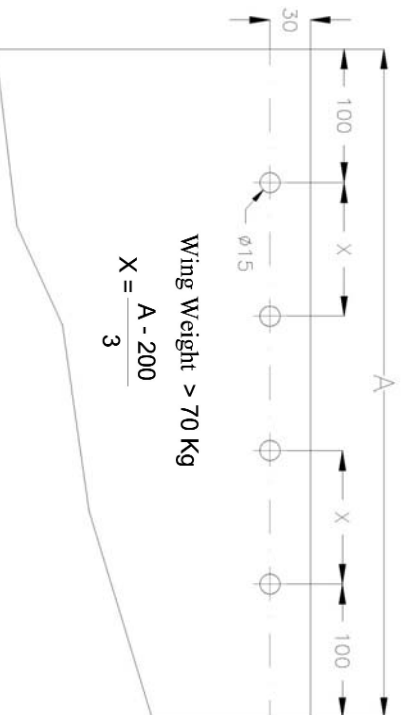

Wing Weight > 70 Kg

$$X = \frac{A - 200}{3}$$

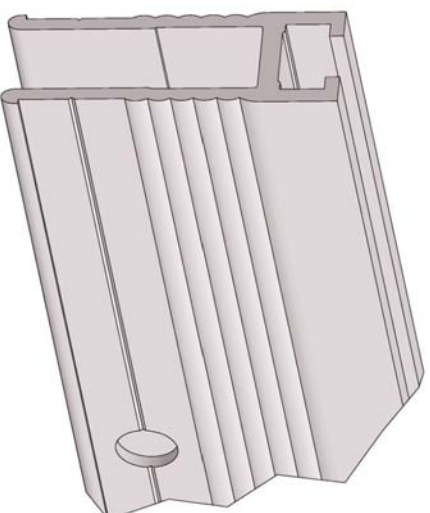

Profile cutting and drilling

For correct working of the profile, proceed as follows:

- Cut the aluminium clamp profile at a height equal to the width of the glass.
- Slip the clamp profile onto the glass and obtain the correct position of the fastening holes.
- Make suitable holes with a diameter of 10.5 mm on the clamp profile.



CAUTION

Make sure that the profile clamp is cut to the same measure as the glass so as to allow the correct application of the profile finishing cap.

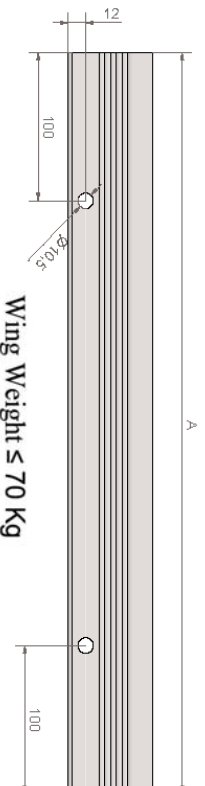

Wing Weight ≤ 70 Kg



CAUTION

The lack of a perfect alignment between the holes made on the aluminium profile clamp and the holes made on the glass will compromise the subsequent assembly of the glass wing clamp.

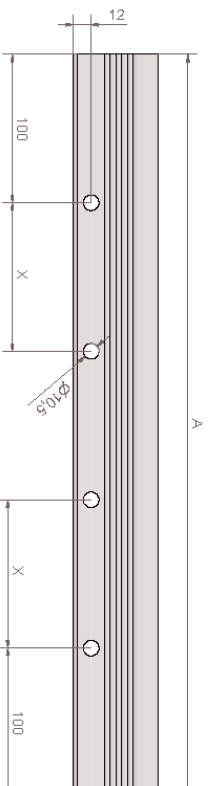

Wing Weight > 70 Kg

$$X = \frac{A - 200}{3}$$

Profile assembly

10 mm GLASS

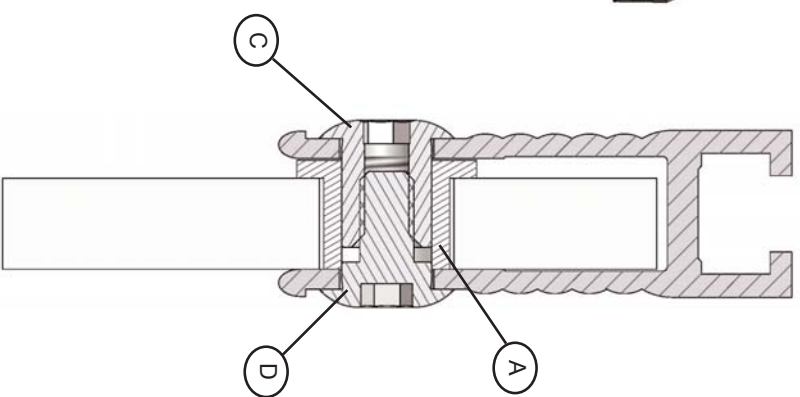
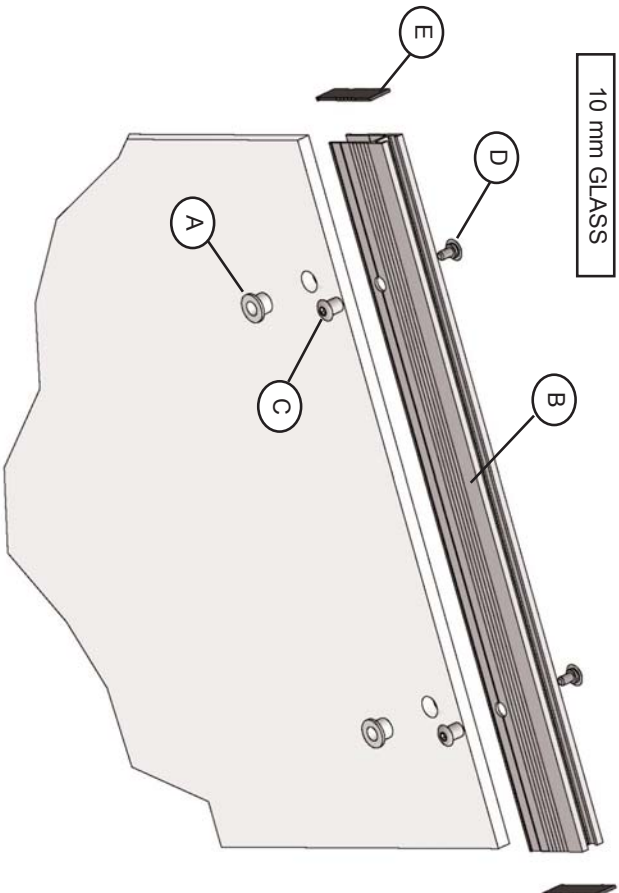

A	Nylon bushing
B	Clamp profile
C	Female boss
D	Male boss
E	Profile finishing cap

For correct assembly of the glass wing, proceed as follows:

- Position the appropriate Nylon bushings (A), chosen on the basis of the glass to be used, inside the holes.
- Slip the clamp profile (B) onto the glass, aligning the fastening holes made on the profile with the holes on the glass.
- Insert the female bosses (C) and male bosses (D) inside the fastening holes.
- Screw on the bosses with a tightening torque equal to 5 Nm
- Apply the special profile finishing cap (E) to the two ends of the glass wing clamp.

Use M8 x 16 hexagon screws with plain serrated washer for fastening to the automatism carriages.

12 mm GLASS

